



Gaston County

Gaston County
Board of Commissioners
www.gastongov.com

Public Works

Board Action

File #: 18-433

Commissioner Jack Brown - Public Works - To Accept an Offer to Purchase a County Owned Surplus Parcel (PID 103983 located off North Oakland Street, Gastonia) and Authorize Staff to Initiate the Upset Bid Process

STAFF CONTACT

Ray Maxwell, PE, Director - Public Works - 704-862-7551

BUDGET IMPACT

No additional County funds.

BUDGET ORDINANCE IMPACT

N/A

BACKGROUND

Gaston County currently owns a 0.45 acre parcel, PID 103983, located off North Oakland Street, Gastonia with a current tax value of \$1,687.00. On April 12, 2007 the Gaston County Board of Commissioners declared this non-essential, County-owned parcel as surplus and authorized staff to initiate sale procedures pursuant to applicable North Carolina General Statute. This parcel is not in an area the County is planning to redevelop, nor is it planned for current or future development for County use.

The Public Works Office has received an offer in the amount of \$300.00 from Coast 2 Coast Group, LLC. to purchase this parcel, PID 103983. Approval of this Board Action formally accepts the offer and authorizes staff to proceed with the upset bid process.

Under G.S 160A-269, a County has the authority to "receive, solicit, or negotiate an offer to purchase property and advertise it for upset bids." Under this statute, if the Board of Commissioners accepts the offer for this property, the County must then advertise the bid in the newspaper and allow ten (10) days for other bids to be received. Staff will bring the highest and best offer back to the Commission for final approval.

POLICY IMPACT

N/A

ATTACHMENTS

Surplus Property Maps

DO NOT TYPE BELOW THIS LINE

I, Donna S. Buff, Clerk to the County Commission, do hereby certify that the above is a true and correct copy of action taken by the Board of Commissioners as follows:

NO.	DATE	M1	M2	CBrown	JBrown	AFriley	BHovis	TKelgher	TPhillbeck	RWorley	Vote
2018-310	12/11/2018	JB	BH	AB	A	AB	A	A	A	A	U

DISTRIBUTION:

Laserfiche Users

A=AYE, N=NAY, AB=ABSENT, ABS=ABSTAIN, U=UNANIMOUS

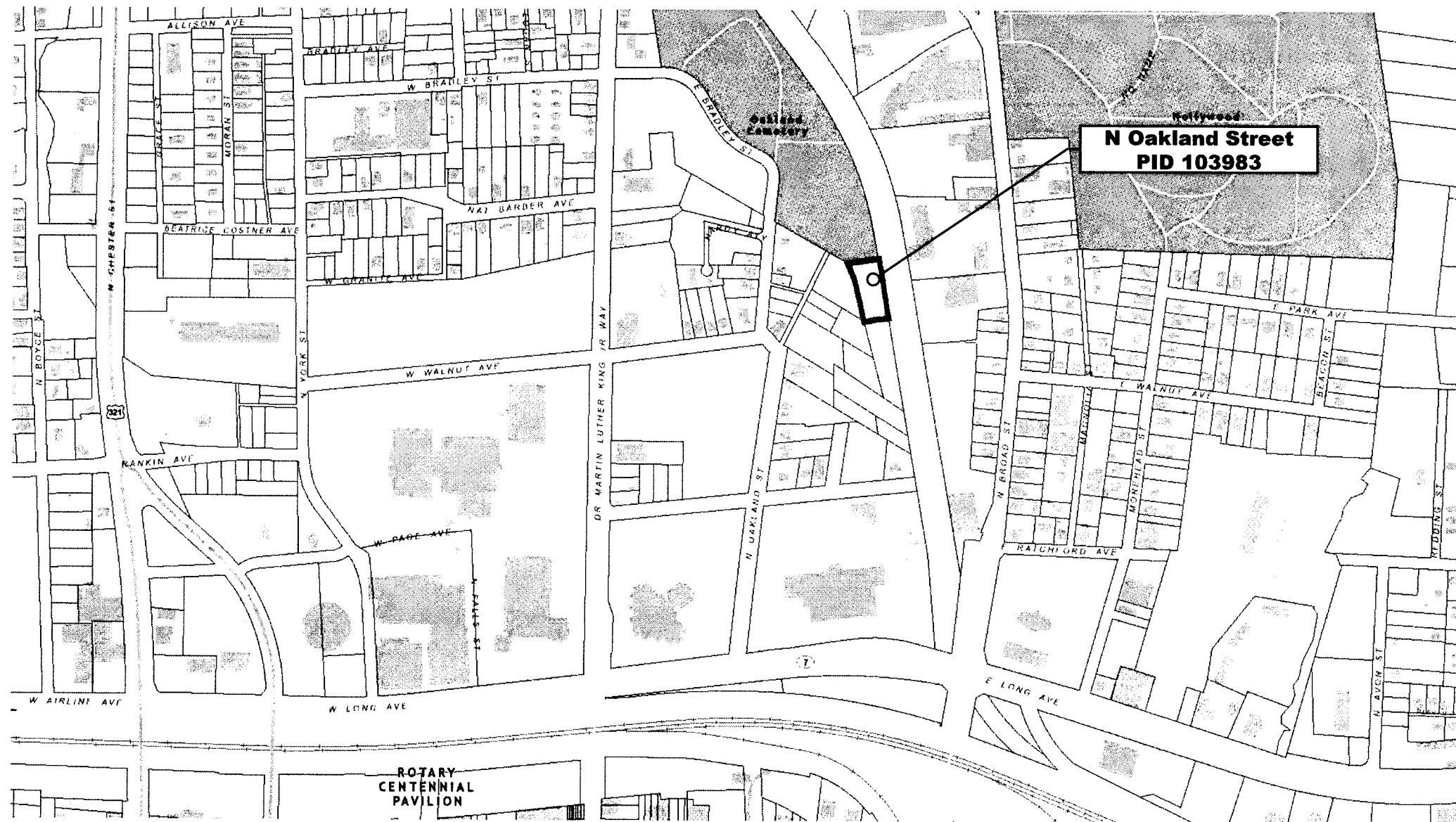



N Oakland Street
PID 103983

This is an aerial photograph of a city street grid. A white dot is placed on N Oakland Street, between W Walnut Ave and W Long Ave. The map shows various streets including Allison Ave, Bradley St, W Bradley St, W Walnut Ave, W Long Ave, Rankin Ave, N Christy St, N Oakland St, N Broad St, N Park Ave, N Long St, N Avon St, E Long Ave, E Broad St, E Walnut Ave, E Park Ave, E 1st St, E 2nd St, E 3rd St, E 4th St, E 5th St, E 6th St, E 7th St, E 8th St, E 9th St, E 10th St, E 11th St, E 12th St, E 13th St, E 14th St, E 15th St, E 16th St, E 17th St, E 18th St, E 19th St, E 20th St, E 21st St, E 22nd St, E 23rd St, E 24th St, E 25th St, E 26th St, E 27th St, E 28th St, E 29th St, E 30th St, E 31st St, E 32nd St, E 33rd St, E 34th St, E 35th St, E 36th St, E 37th St, E 38th St, E 39th St, E 40th St, E 41st St, E 42nd St, E 43rd St, E 44th St, E 45th St, E 46th St, E 47th St, E 48th St, E 49th St, E 50th St, E 51st St, E 52nd St, E 53rd St, E 54th St, E 55th St, E 56th St, E 57th St, E 58th St, E 59th St, E 60th St, E 61st St, E 62nd St, E 63rd St, E 64th St, E 65th St, E 66th St, E 67th St, E 68th St, E 69th St, E 70th St, E 71st St, E 72nd St, E 73rd St, E 74th St, E 75th St, E 76th St, E 77th St, E 78th St, E 79th St, E 80th St, E 81st St, E 82nd St, E 83rd St, E 84th St, E 85th St, E 86th St, E 87th St, E 88th St, E 89th St, E 90th St, E 91st St, E 92nd St, E 93rd St, E 94th St, E 95th St, E 96th St, E 97th St, E 98th St, E 99th St, E 100th St. Other labels include 'DR. MARTIN LUTHER KING JR. WAY', 'W. AIRLINE AVE', 'W. LONG AVE', 'RANKIN AVE', 'N. CHRISTY ST', 'N. OAKLAND ST', 'N. BROAD ST', 'N. PARK AVE', 'N. LONG ST', 'N. AVON ST', 'E. LONG AVE', 'E. BROAD ST', 'E. WALNUT AVE', 'E. PARK AVE', 'E. 1ST ST', 'E. 2ND ST', 'E. 3RD ST', 'E. 4TH ST', 'E. 5TH ST', 'E. 6TH ST', 'E. 7TH ST', 'E. 8TH ST', 'E. 9TH ST', 'E. 10TH ST', 'E. 11TH ST', 'E. 12TH ST', 'E. 13TH ST', 'E. 14TH ST', 'E. 15TH ST', 'E. 16TH ST', 'E. 17TH ST', 'E. 18TH ST', 'E. 19TH ST', 'E. 20TH ST', 'E. 21ST ST', 'E. 22ND ST', 'E. 23RD ST', 'E. 24TH ST', 'E. 25TH ST', 'E. 26TH ST', 'E. 27TH ST', 'E. 28TH ST', 'E. 29TH ST', 'E. 30TH ST', 'E. 31ST ST', 'E. 32ND ST', 'E. 33RD ST', 'E. 34TH ST', 'E. 35TH ST', 'E. 36TH ST', 'E. 37TH ST', 'E. 38TH ST', 'E. 39TH ST', 'E. 40TH ST', 'E. 41ST ST', 'E. 42ND ST', 'E. 43RD ST', 'E. 44TH ST', 'E. 45TH ST', 'E. 46TH ST', 'E. 47TH ST', 'E. 48TH ST', 'E. 49TH ST', 'E. 50TH ST', 'E. 51ST ST', 'E. 52ND ST', 'E. 53RD ST', 'E. 54TH ST', 'E. 55TH ST', 'E. 56TH ST', 'E. 57TH ST', 'E. 58TH ST', 'E. 59TH ST', 'E. 60TH ST', 'E. 61ST ST', 'E. 62ND ST', 'E. 63RD ST', 'E. 64TH ST', 'E. 65TH ST', 'E. 66TH ST', 'E. 67TH ST', 'E. 68TH ST', 'E. 69TH ST', 'E. 70TH ST', 'E. 71ST ST', 'E. 72ND ST', 'E. 73RD ST', 'E. 74TH ST', 'E. 75TH ST', 'E. 76TH ST', 'E. 77TH ST', 'E. 78TH ST', 'E. 79TH ST', 'E. 80TH ST', 'E. 81ST ST', 'E. 82ND ST', 'E. 83RD ST', 'E. 84TH ST', 'E. 85TH ST', 'E. 86TH ST', 'E. 87TH ST', 'E. 88TH ST', 'E. 89TH ST', 'E. 90TH ST', 'E. 91ST ST', 'E. 92ND ST', 'E. 93RD ST', 'E. 94TH ST', 'E. 95TH ST', 'E. 96TH ST', 'E. 97TH ST', 'E. 98TH ST', 'E. 99TH ST', 'E. 100TH ST'. A white dot is located on N Oakland Street, between W Walnut Ave and W Long Ave.