

REZ-24-10-14-00194

Case Type

Applicant:

Tony Torrence

PID:

193762

Request:

General Rezoning Request from the (R-1) Single Family Limited zoning district with US and CH overlays to the (R-2) Single Family Moderate zoning district with US and CH overlays



VICINITY MAP

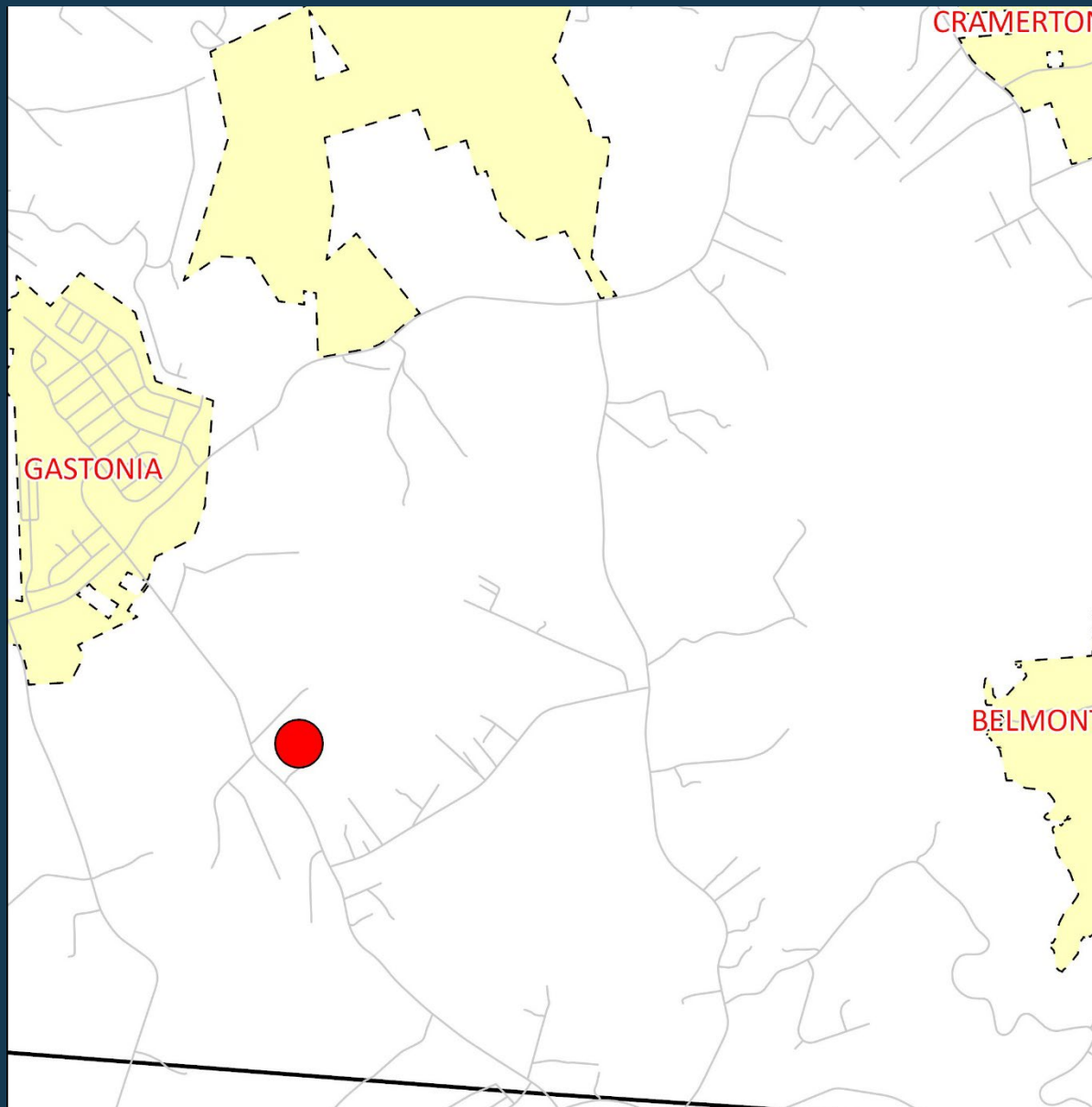

LEGEND

- Roads
- ▭ Municipalities
- Subject Property



The information provided is not intended to be considered as a legal document or description. This map is believed to be accurate, but Gaston County does not guarantee its accuracy. Maps in this presentation may not be resold, or otherwise used for trade or commercial purposes as defined by NCGS 132-10.



ORTHOPHOTO MAP



LEGEND

-  Subject Parcel
-  Property Parcels

The information provided is not intended to be considered as a legal document or description. This map is believed to be accurate, but Gaston County does not guarantee its accuracy. Maps in this presentation may not be resold, or otherwise used for trade or commercial purposes as defined by NCGS 132-10.

REZONING MAP

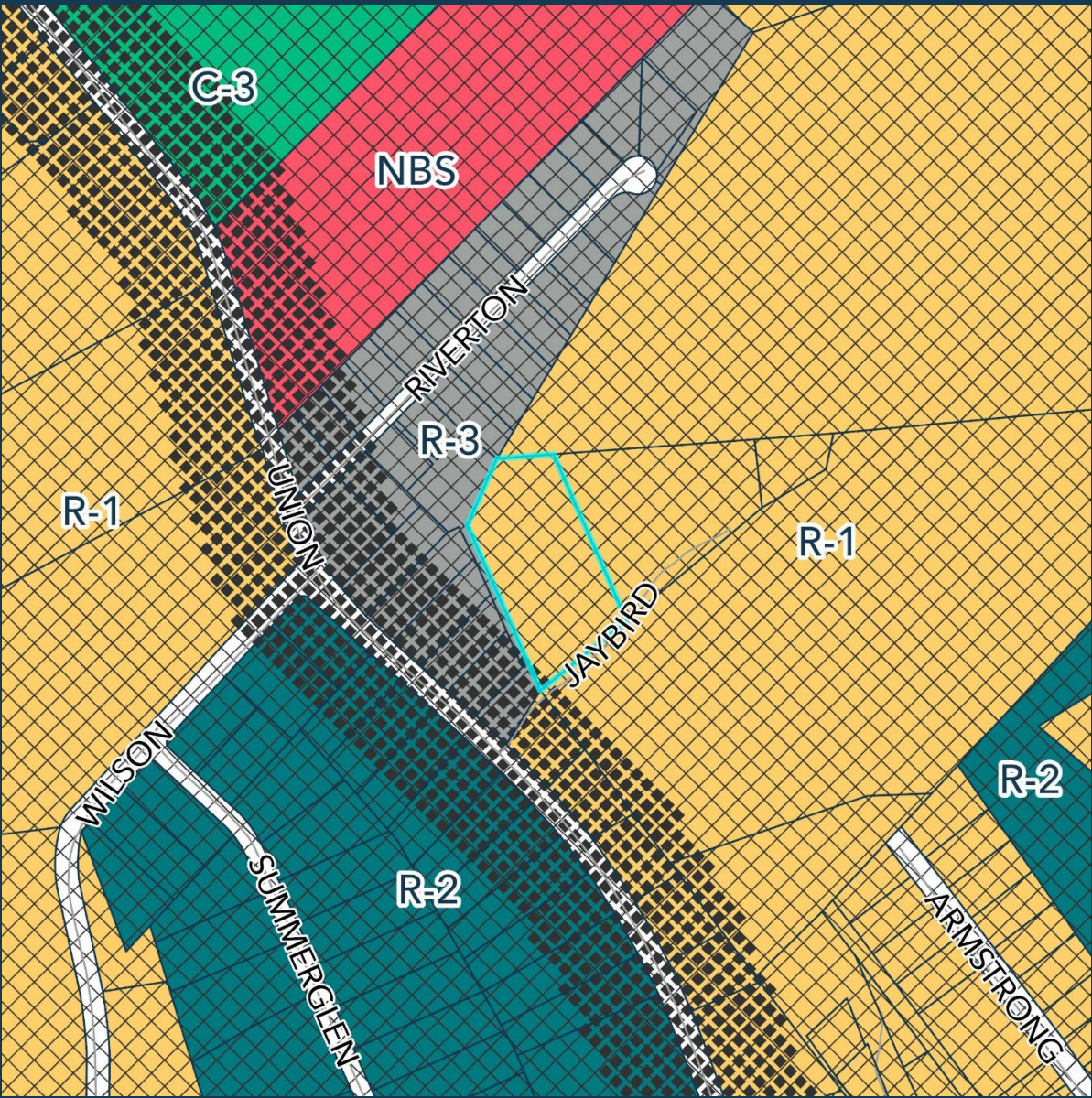

LEGEND

- Roads
- ▭ Parcels
- ZONE TYPE**
- ▭ C-3
- ▭ NBS
- ▭ R-1
- ▭ R-2
- ▭ R-3
- ▭ Subject Parcel

The information provided is not intended to be considered as a legal document or description. This map is believed to be accurate, but Gaston County does not guarantee its accuracy. Maps in this presentation may not be resold, or otherwise used for trade or commercial purposes as defined by NCGS 132-10.



SUBJECT & ADJACENT PARCELS

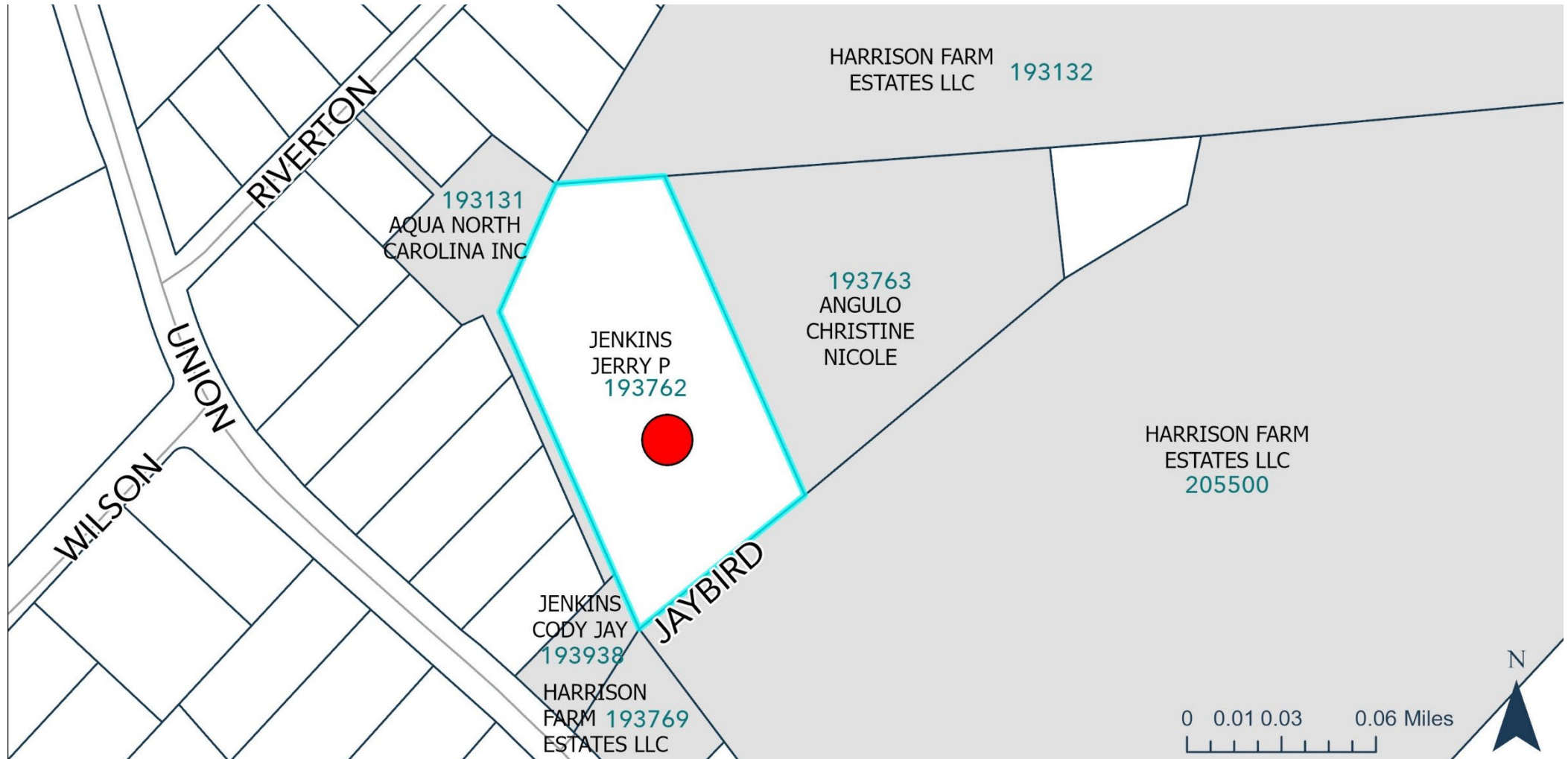

The information provided is not intended to be considered as a legal document or description. This map is believed to be accurate, but Gaston County does not guarantee its accuracy. Maps in this presentation may not be resold, or otherwise used for trade or commercial purposes as defined by NCGS 132-10.

PROPERTY OWNERS INFORMATION

PARCEL ID	NAME 1	NAME 2	ADDRESS	CITY	STATE	ZIPCODE
193763	PUTMAN NOAH S	ANGULO C CHRISTINE NICOLE	126 JAYBIRD LN	GASTONIA	NC	28056
193125	SMITH CYNTHIA	SMITH ROGER	122 RIVERTON PLACE	GASTONIA	NC	28056
193126	WHITTED VANCE JUNIOR		118 RIVERTON PLACE	GASTONIA	NC	28056
193934	MELTON STEPHEN RANDALL	MELTON BARBARA M	6511 UNION ROAD	GASTONIA	NC	28054
193131	AQUA NORTH CAROLINA INC		202 MACKENAN DR	CARY	NC	27511
193769	HARRISON FARM ESTATES LLC		308 INLAND COVE CT	LAKE WYLIE	SC	29710
193132	HARRISON FARM ESTATES LLC		308 INLAND COVE CT	LAKE WYLIE	SC	29710
193935	POTEAT DANNY LEE	POTEAT JESSICA M	6521 UNION RD	GASTONIA	NC	28056
193938	JENKINS CODY JAY		110 JAYBIRD LN	GASTONIA	NC	28056
205500	HARRISON FARM ESTATES LLC		308 INLAND COVE CT	LAKE WYLIE	SC	29710
193937	POTEAT DANNY LEE	POTEAT JESSICA MASSENGILL	6521 UNION RD	GASTONIA	NC	28056
193762	JENKINS JERRY P	JENKINS BRENDA G	110 JAYBIRD LN	GASTONIA	NC	28056
193933	MELTON MICHAEL W	MELTON DONNA C	521 PEACEFUL CREEK DR	YORK	SC	29745
193936	MESSER JACK REID		6517 UNION RD	GASTONIA	NC	28056

Utilities & Streets



- **Private Well**
- **Private Septic**



- **Private Easement off of an NCDOT road**

Overview

- **Small Area Plan:** Area 4 –
The Garden
Gaston/Southeast Gaston
- **Future Land Use
Designation:** Rural
Community