

Z22-05 General Rezoning Request

Applicant and Owner(s): Boyd & Aleta West

Parcel: 218666

Location: Puetts Chapel Rd. and End of the Trail

Request: Rezone 1.19 acres out of 2.11 acres from the (R-1) Single Family Limited Zoning District to the (R-2) Single Family Moderate Zoning District



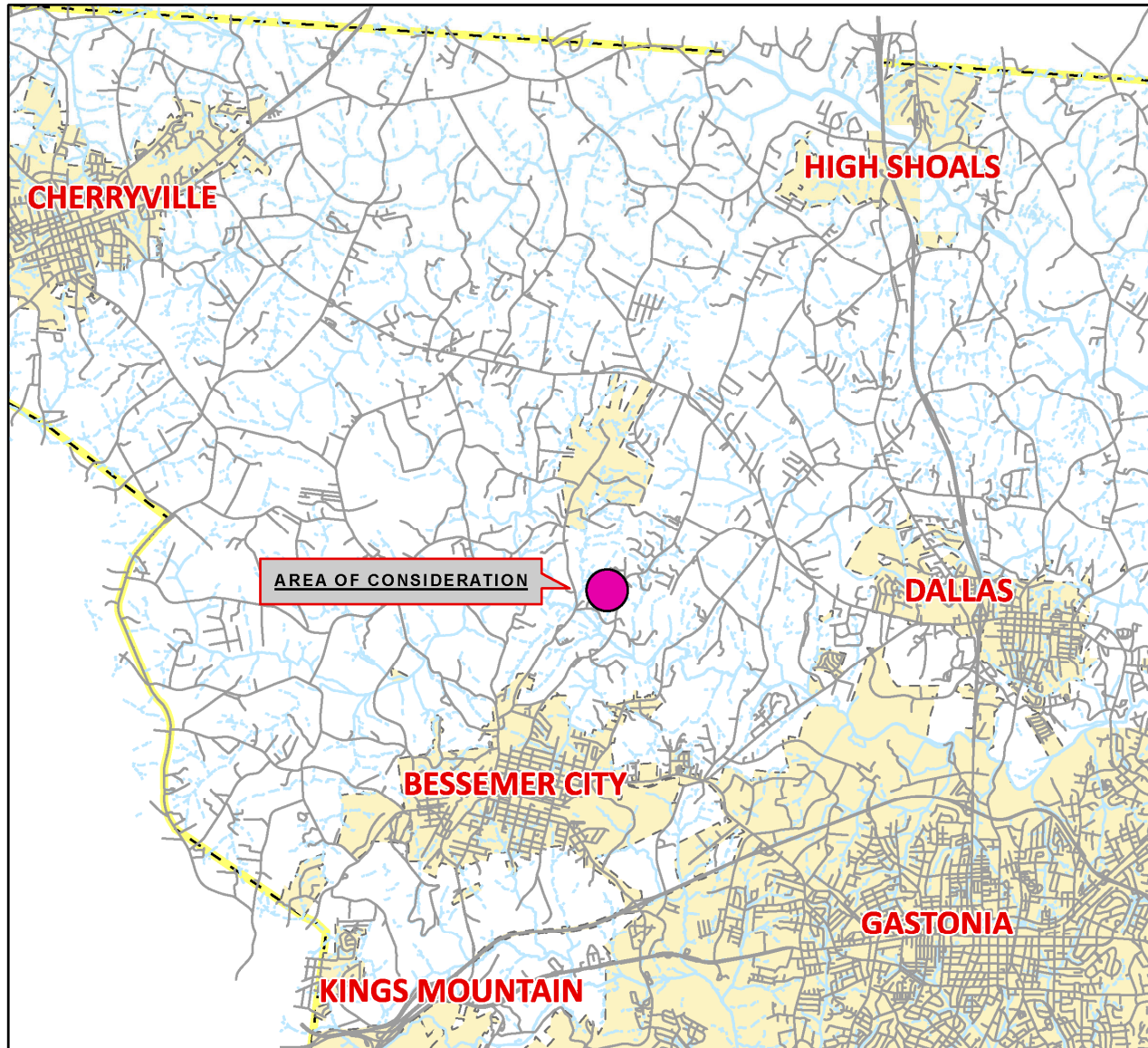

GASTON COUNTY
BUILDING AND DEVELOPMENT SERVICES

VICINITY MAP Z22-05

LEGEND

— Roads

— Municipalities

● Area of Consideration

Although strict accuracy standards have been employed in the compilation of this map, Gaston County does not make or imply any warranties or assume any responsibility for the information presented on this map or its use.

This map may not be resold or otherwise used for trade or commercial purposes without the expressed written consent of Gaston County, in accordance with North Carolina General Statute 132-10.



0 0.75 1.5 Miles



GASTON COUNTY
BUILDING AND DEVELOPMENT SERVICES

ORTHOPHOTO MAP Z22-05

LEGEND

-  Subject Area
-  Property Parcels

This map is intended for use by the Gaston County Board of Commissioners, in the review of rezoning requests.

Property parcels, zoning, transportation, and other map information were compiled from one of more data layers. the data is periodically updated, however all data layers may not be displayed. Street names are subject to change.

Gaston County does not make or imply any warranties or assume any responsibility for the information presented on this map. This map was prepared by the Building and Development Services Department.

This map is for zoning purposes only - Not to be used for conveyance.

0 180
Feet

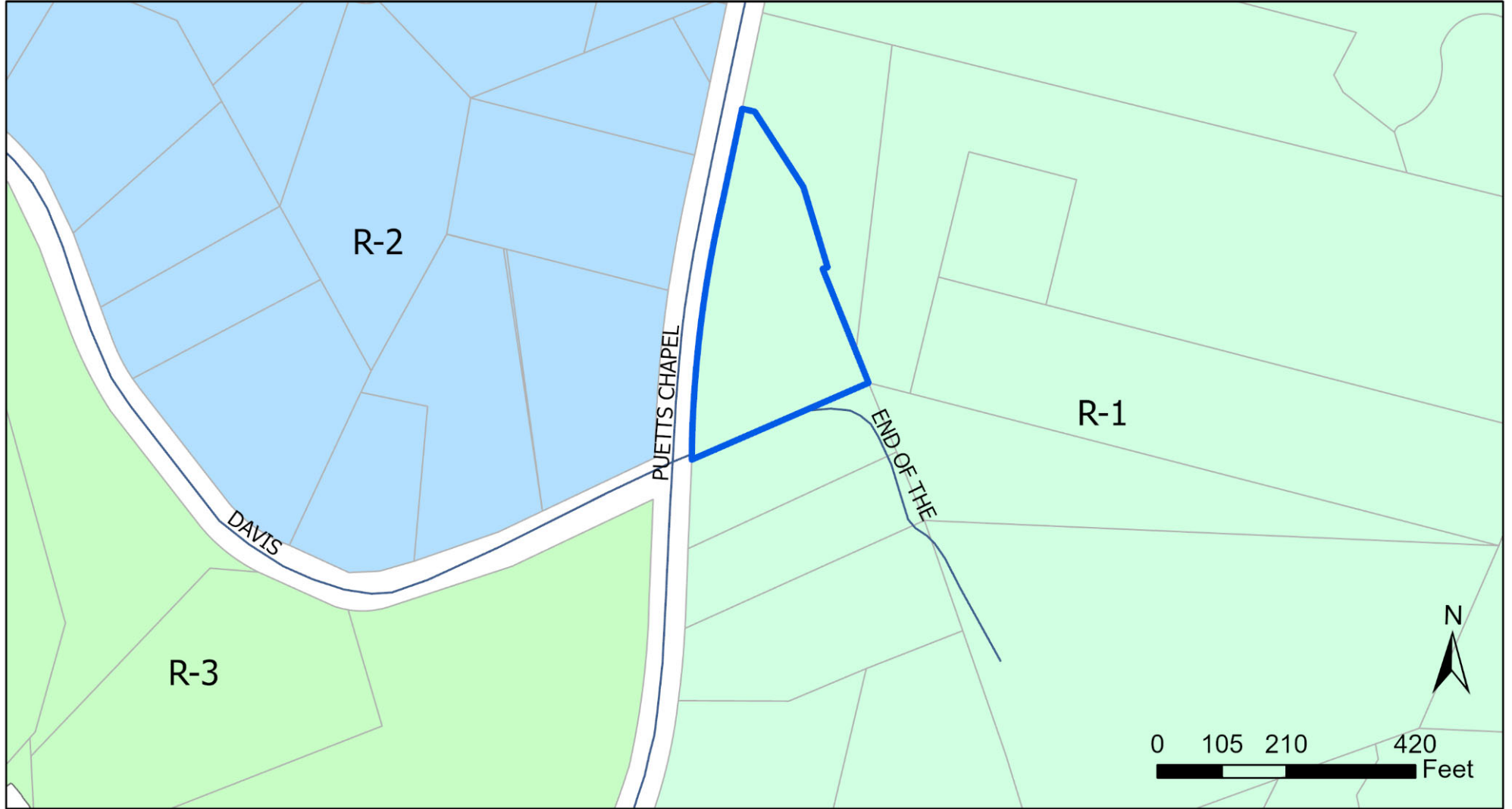

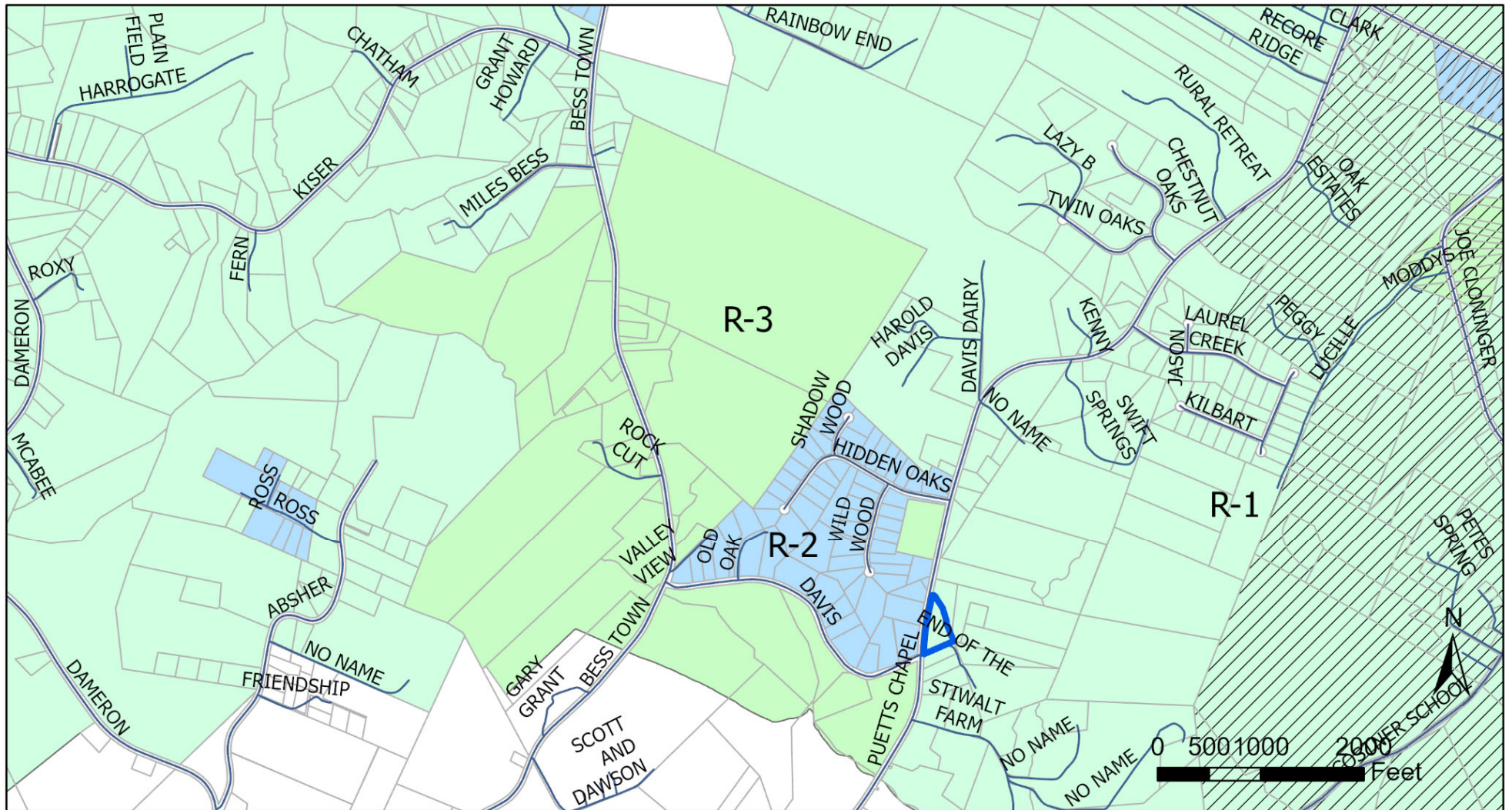

Z22-05 Subject and Adjacent Properties Map

★ SUBJECT PROPERTY

