

REZ-24-06-05-00182

General Rezoning

Applicant: Jonathan Wiley

PID: 166759

Request: General Rezoning request from (R-1) Single Family Limited to (R-2) Single Family Moderate



VICINITY MAP

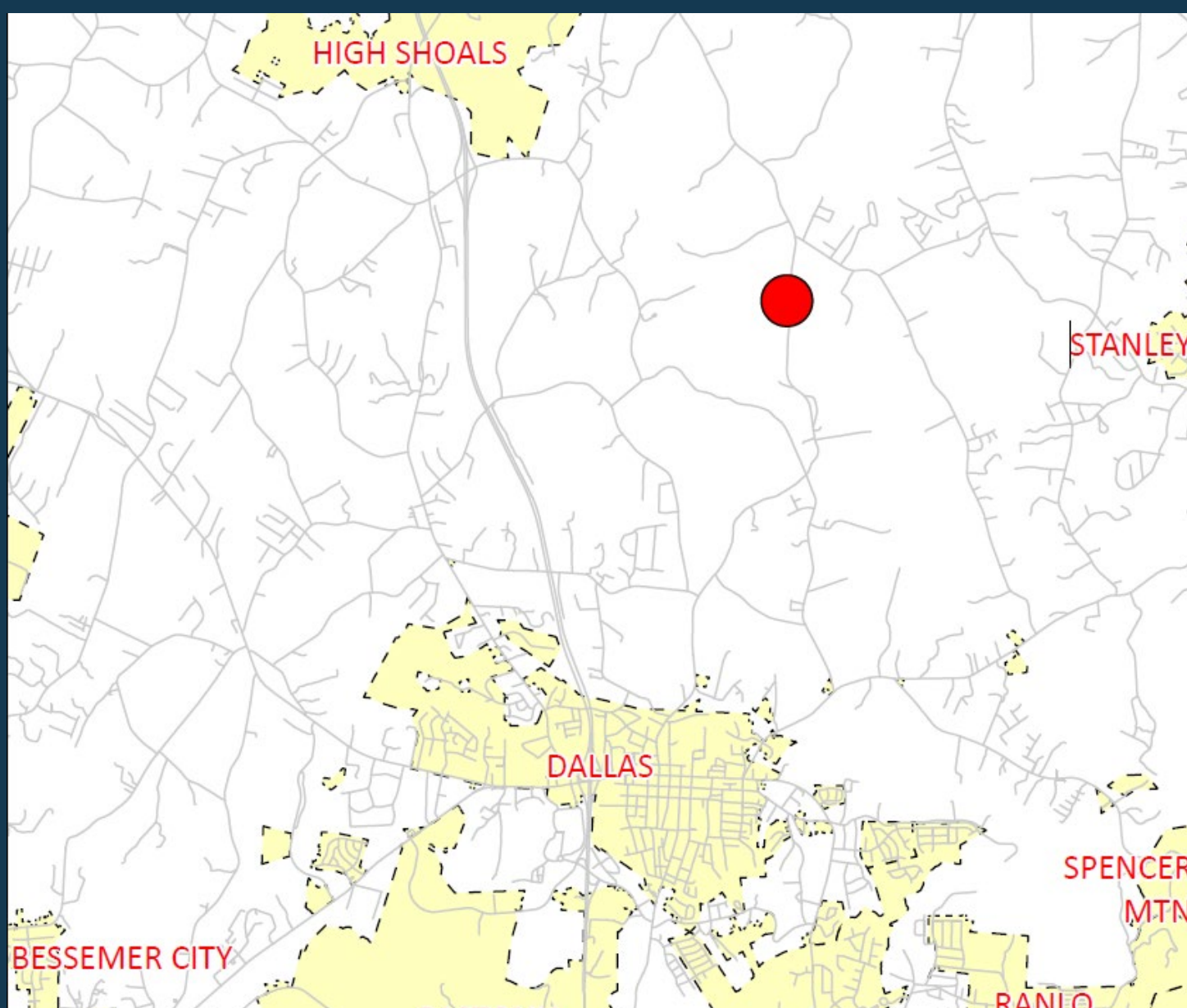

LEGEND

- Roads
- ▭ Municipalities
- Subject Property

The information provided is not intended to be considered as a legal document or description. This map is believed to be accurate, but Gaston County does not guarantee its accuracy. Maps in this presentation may not be resold, or otherwise used for trade or commercial purposes as defined by NCGS 132-10.



ORTHOPHOTO MAP



LEGEND

-  Subject Parcel
-  Property Parcels

The information provided is not intended to be considered as a legal document or description. This map is believed to be accurate, but Gaston County does not guarantee its accuracy. Maps in this presentation may not be resold, or otherwise used for trade or commercial purposes as defined by NCGS 132-10.



REZONING MAP

LEGEND

 Subject Parcel

 Roads

 Parcels

ZONE TYPE

 C-1

 R-1

 R-2

 R-3

 Rivers

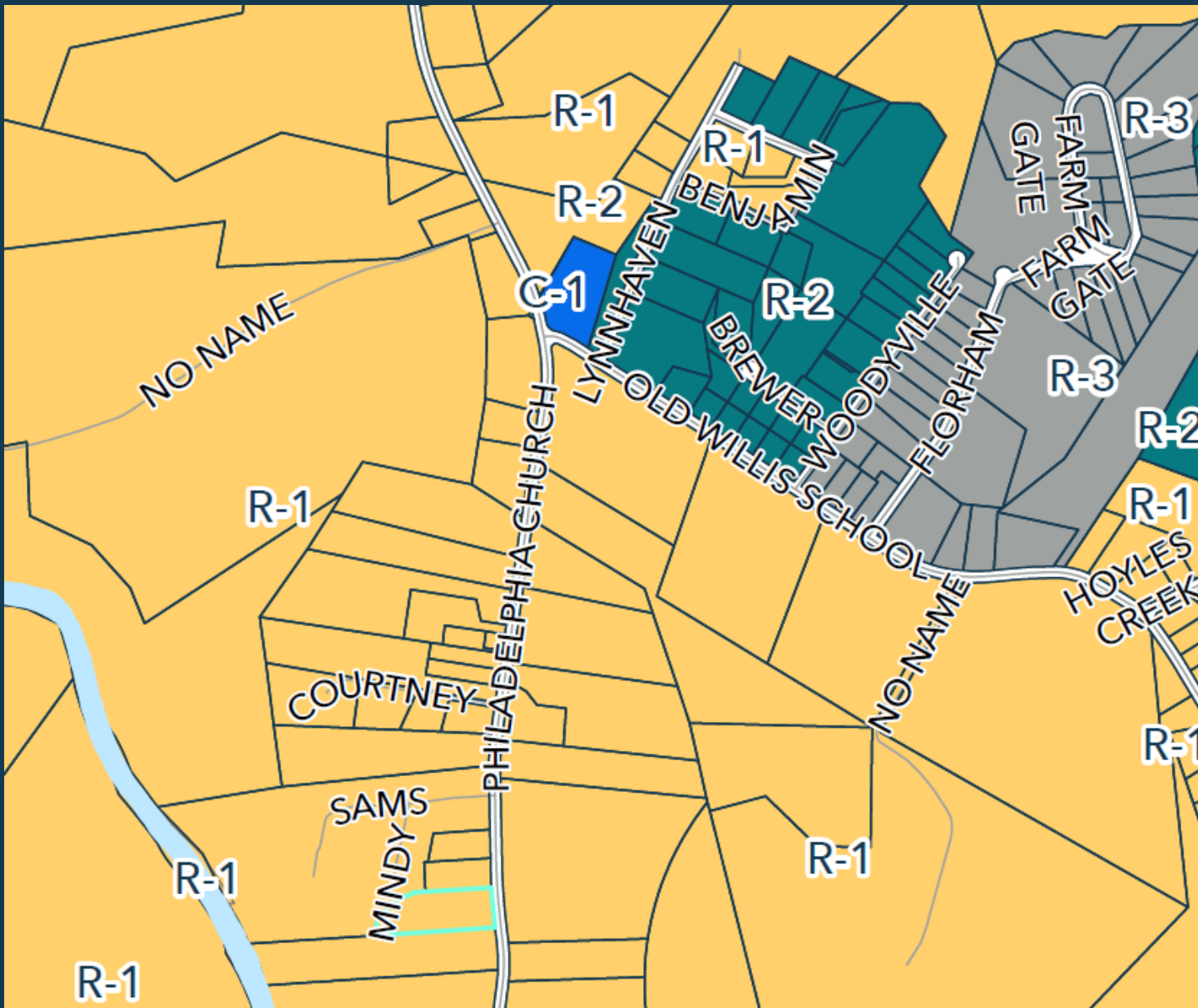

The information provided is not intended to be considered as a legal document or description. This map is believed to be accurate, but Gaston County does not guarantee its accuracy. Maps in this presentation may not be resold, or otherwise used for trade or commercial purposes as defined by NCGS 132-10.

SUBJECT & ADJACENT PARCELS

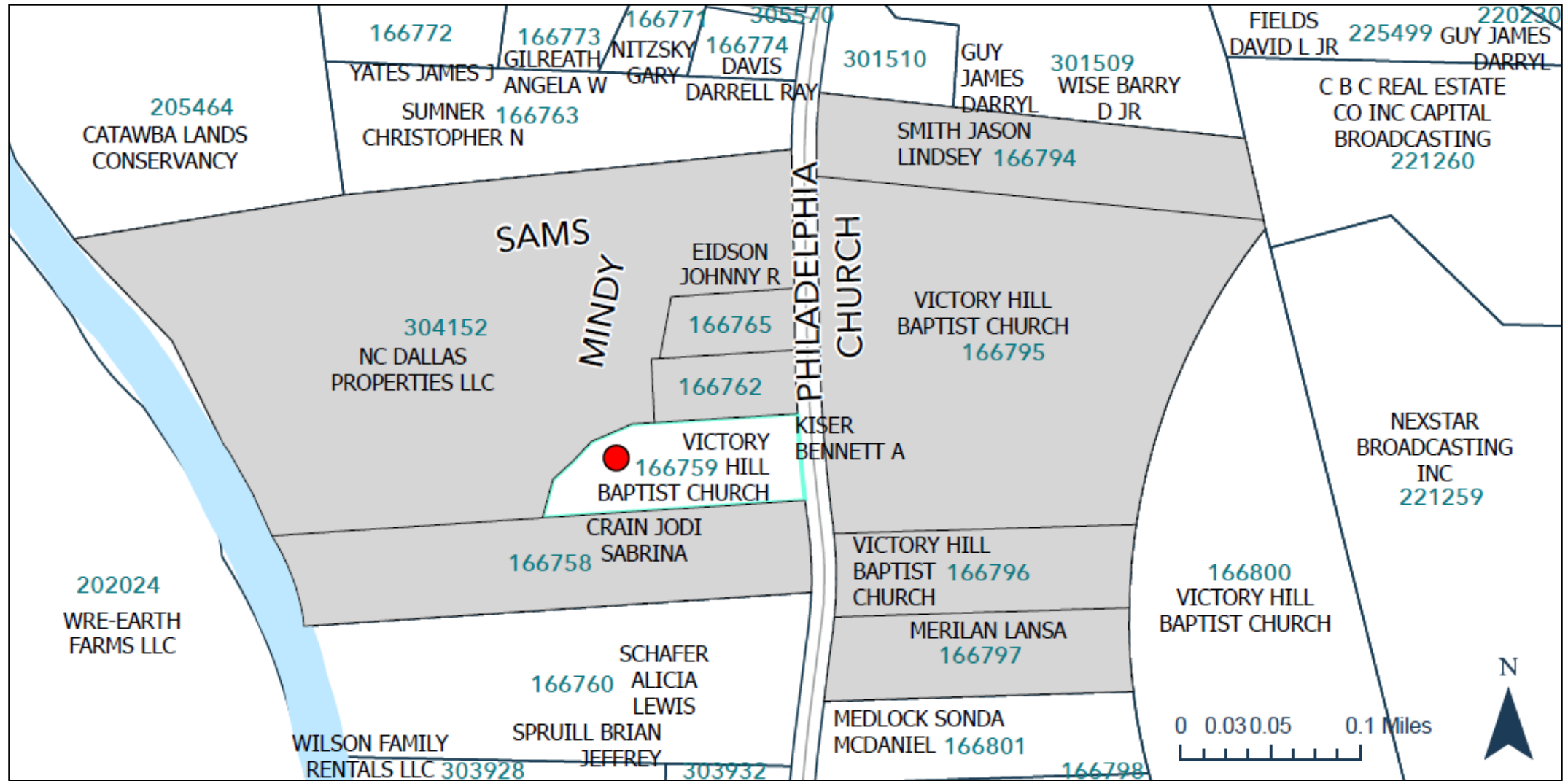

The information provided is not intended to be considered as a legal document or description. This map is believed to be accurate, but Gaston County does not guarantee its accuracy. Maps in this presentation may not be resold, or otherwise used for trade or commercial purposes as defined by NCGS 132-10.



PROPERTY OWNERS INFORMATION

PARCEL ID	NAME 1	NAME 2	ADDRESS	CITY	STATE	ZIP
166759	VICTORY HILL BAPTIST CHURCH		PO BOX 638	DALLAS	NC	28034
166758	CRAIN JODI SABRINA	CRAIN MARK DEWAYNE	2225 PHILADELPHIA CHURCH RD	DALLAS	NC	28034
166762	KISER BENNETT A	KISER KAELA R	2241 PHILADELPHIA CHRUCH ROAD	DALLAS	NC	28034
166765	EIDSON JOHNNY R	EIDSON JOYCE H	2249 PHILADELPHIA CHURCH RD	DALLAS	NC	28034
166794	SMITH JASON LINDSEY	SMITH SHANNON FRIDAY	2310 PHILADELPHIA CHURCH ROAD	DALLAS	NC	28034
166795	VICTORY HILL BAPTIST CHURCH		PO BOX 638	DALLAS	NC	28034
166796	VICTORY HILL BAPTIST CHURCH		PO BOX 638	DALLAS	NC	28034
166797	MERILAN LANSA		2228 PHILADELPHIA CHURCH RD	DALLAS	NC	28034
304152	NC DALLAS PROPERTIES LLC		138 FINGERBOARD ROAD	STATEN ISLAND	NY	10305

Utilities & Streets



- **Private well**
- **Private Septic**



- **NCDOT**

Overview

- **Area 2: North 321 Gaston**
- **Future Land Use: Rural**
- **TRC Comments**
- **Staff Recommendation**