

GASTON COUNTY
BUILDING AND DEVELOPMENT SERVICES

VICINITY MAP
REZ-25-04-10-00226

LEGEND

- Roads
- ▭ Municipalities
- Subject Parcel

The information provided on this map is not intended to be considered as a legal document or description. The GIS data provided by Gaston County is made without warranty. Primary sources from which this data was compiled must be consulted for verification of the information contained within. This map may not be resold or otherwise used for trade or commercial purposes without the expressed written consent of Gaston County, in accordance with NCGS





GASTON COUNTY
BUILDING AND DEVELOPMENT SERVICES

ORTHOPHOTO MAP
REZ-25-04-10-00226

LEGEND

- Roads
- ▭ Parcels
- ▭ Subject Parcel

The information provided on this map is not intended to be considered as a legal document or description. The GIS data provided by Gaston County is made without warranty. Primary sources from which this data was compiled must be consulted for verification of the information contained within. This map may not be resold or otherwise used for trade or commercial purposes without the expressed written consent of Gaston County, in accordance with NCGS

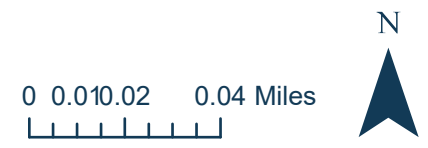



ZONING MAP

REZ-25-04-10-00226

LEGEND

— Roads

▭ Parcels

ZONE TYPE

■ C-1

■ R-1

■ R-2

TYPE

◆◆ CH OVERLAY

×× US OVERLAY

▭ Subject Parcel

The information provided on this map is not intended to be considered as a legal document or description. The GIS data provided by Gaston County is made without warranty. Primary sources from which this data was compiled must be consulted for verification of the information contained within. This map may not be resold or otherwise used for trade or commercial purposes without the expressed written consent of Gaston County, in accordance with NCGS 132-10.

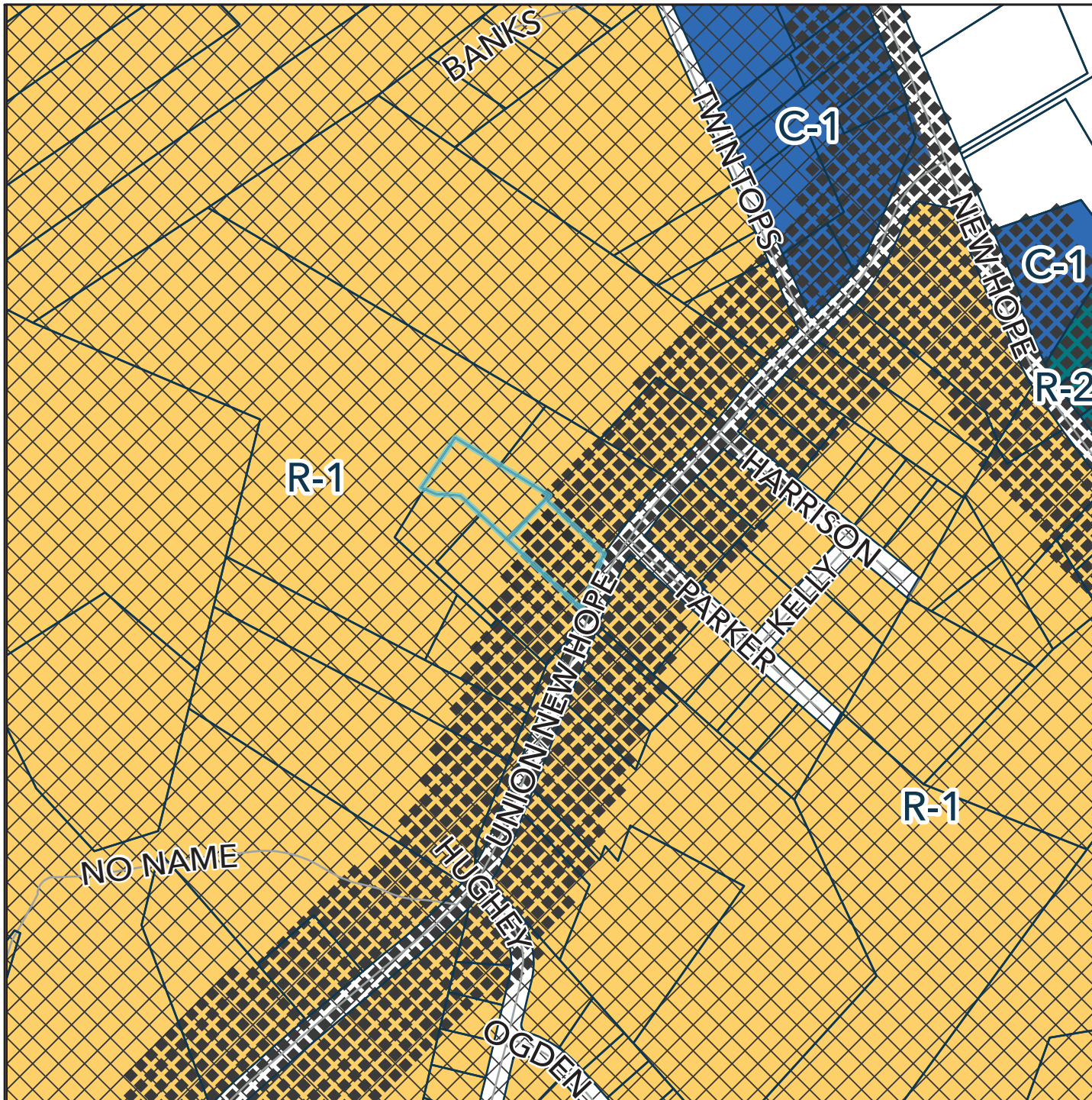
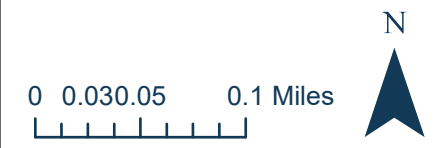



ENVIRONMENTAL MAP REZ-25-04-10-00226

LEGEND

- Roads
- 2ft Contours
- 4ft Contours
- 20ft Contours
- Subject Parcel

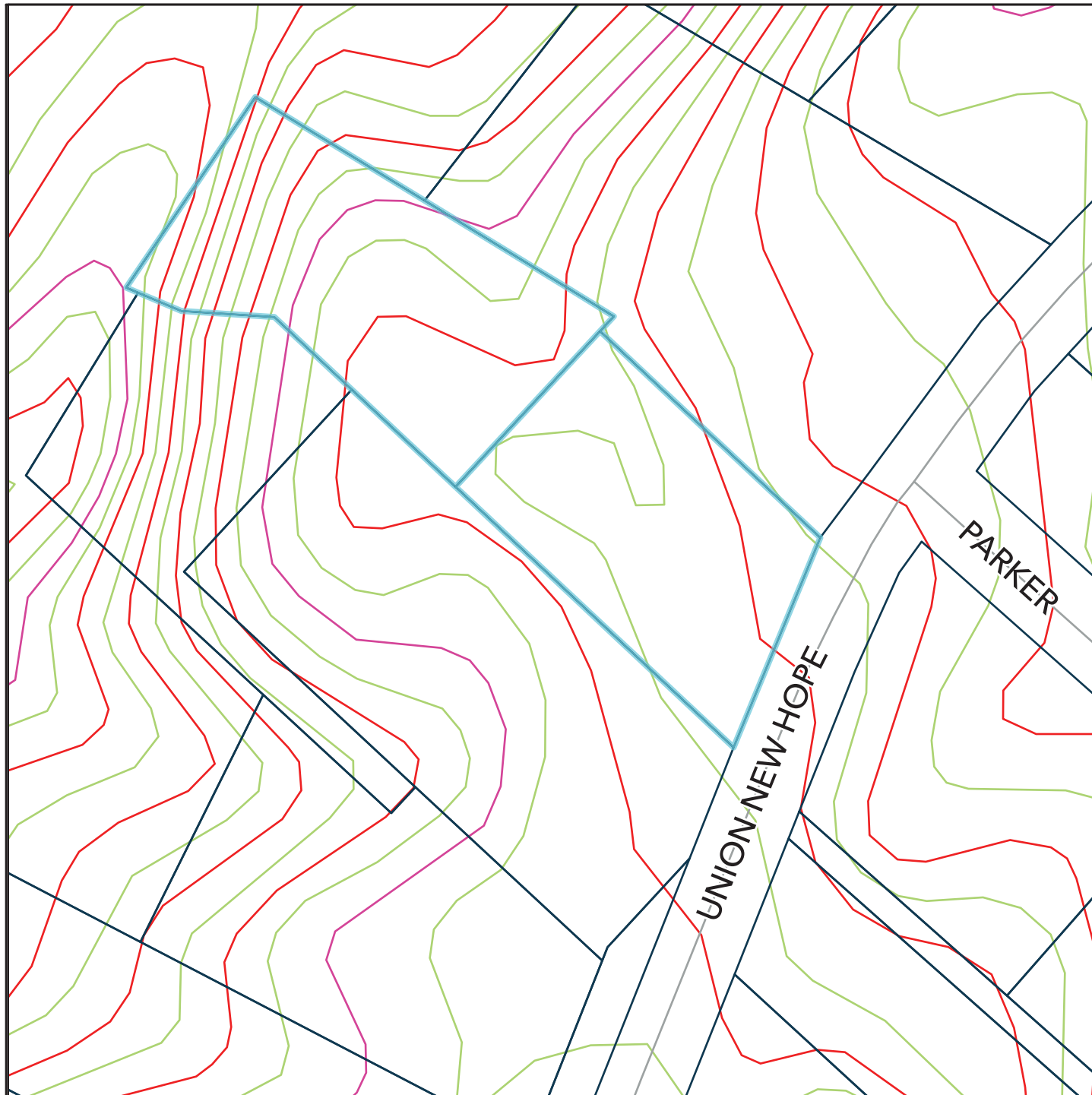

The information provided on this map is not intended to be considered as a legal document or description. The GIS data provided by Gaston County is made without warranty. Primary sources from which this data was compiled must be consulted for verification of the information contained within. This map may not be resold or otherwise used for trade or commercial purposes without the expressed written consent of Gaston County, in accordance with NCGS 132-10.

0 0.00.01 0.02 Miles



N



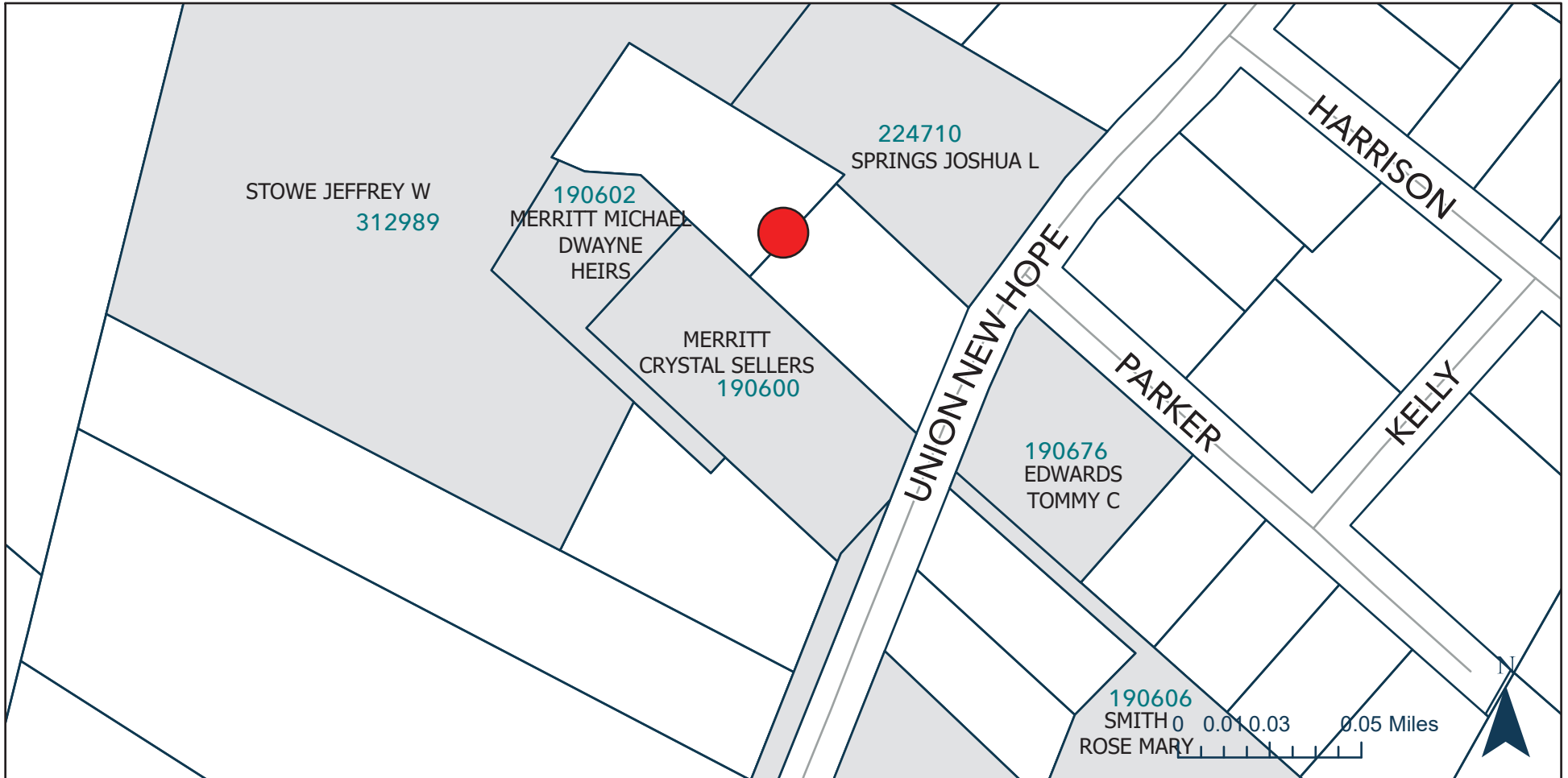

SUBJECT & ADJACENT PROPERTIES MAP | REZ-25-04-10-00226

LEGEND

 Subject Parcel

The information provided on this map is not intended to be considered as a legal document or description. The GIS data provided by Gaston County is made without warranty. Primary sources from which this data was compiled must be consulted for verification of the information contained within. This map may not be resold or otherwise used for trade or commercial purposes without the expressed written consent of Gaston County, in accordance with NCGS 132-10.