







VICINITY MAP REZ-25-03-20-00221

Legend

-  Municipal Zoning District
-  Roads
-  Gaston County Line
-  Subject Parcel(s)

The information provided on this map is not intended to be considered as a legal document or description. The GIS data provided by Gaston County is made without warranty. Primary sources from which this data was compiled must be consulted for verification of the information contained within. This map may not be resold or otherwise used for trade or commercial purposes without the expressed written consent of Gaston County, in accordance with NCGS 132-10.

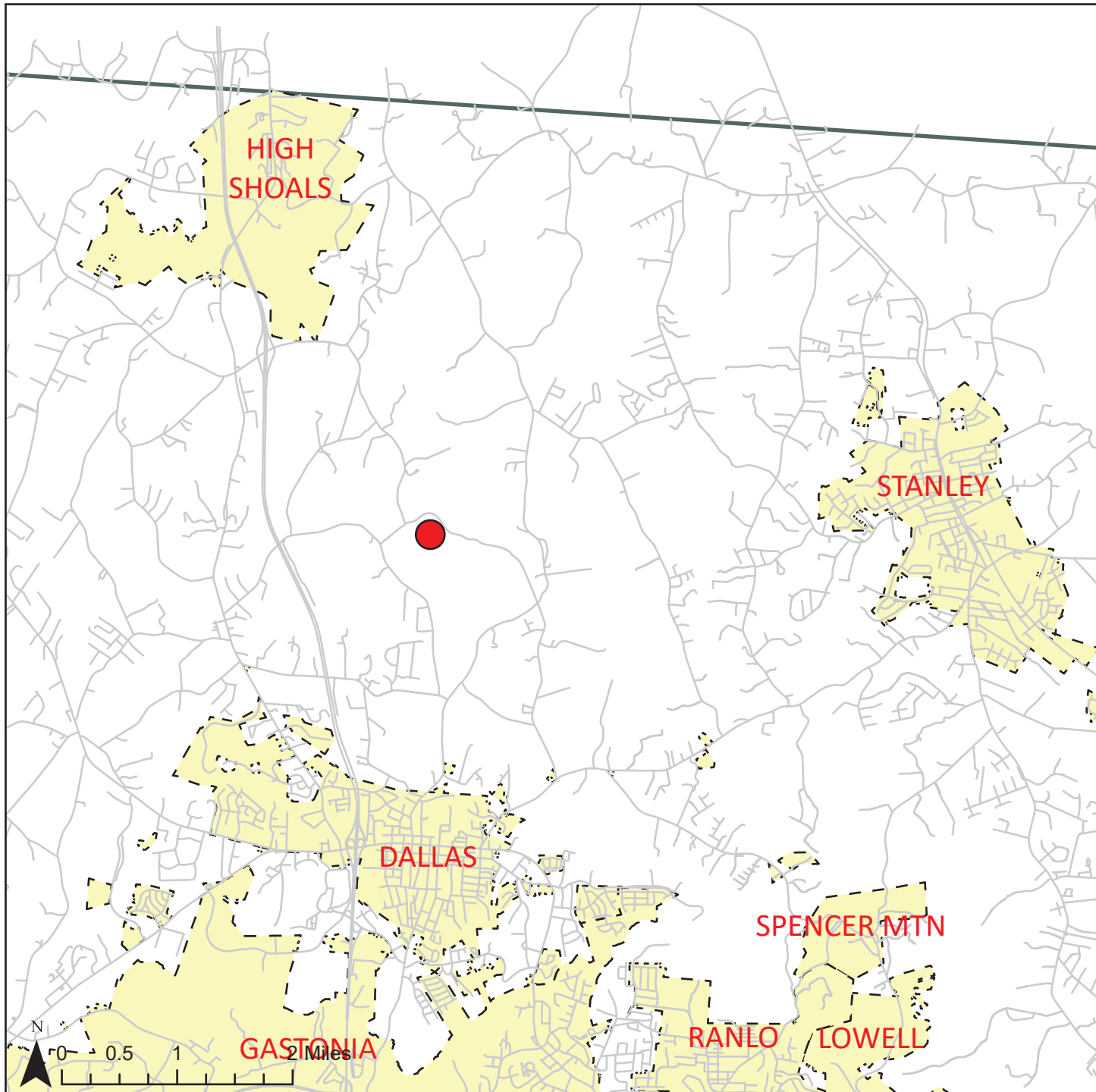

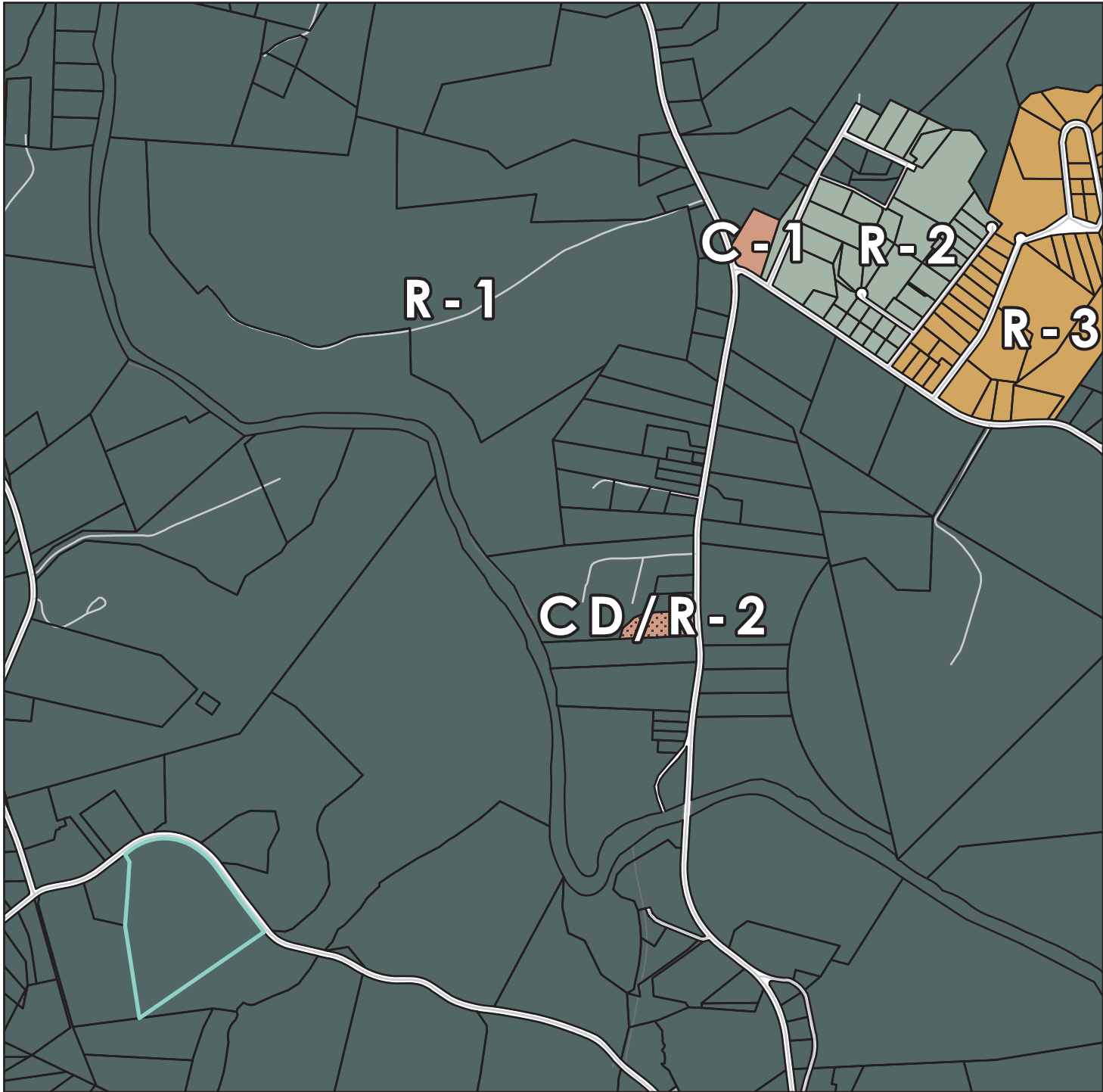

GASTON COUNTY
BUILDING AND DEVELOPMENT SERVICES

ZONING MAP
REZ-25-03-20-00221

Legend

Subject Lot

Gaston County UDO

ZONE TYPE

C-1

CD/R-2

R-1

R-2

R-3

The information provided on this map is not intended to be considered as a legal document or description. The GIS data provided by Gaston County is made without warranty. Primary sources from which this data was compiled must be consulted for verification of the information contained within. This map may not be resold or otherwise used for trade or commercial purposes without the expressed written consent of Gaston County, in accordance with NCGS 132-10.

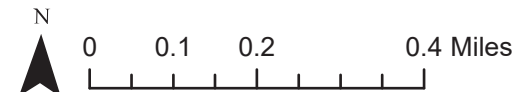



GASTON COUNTY
BUILDING AND DEVELOPMENT SERVICES

ORTHPHOTO MAP
REZ-25-03-20-00221

Legend

-  Subject Lot
-  Roads
-  Parcels

The information provided on this map is not intended to be considered as a legal document or description. The GIS data provided by Gaston County is made without warranty. Primary sources from which this data was compiled must be consulted for verification of the information contained within. This map may not be resold or otherwise used for trade or commercial purposes without the expressed written consent of Gaston County, in accordance with NCGS 132-10.

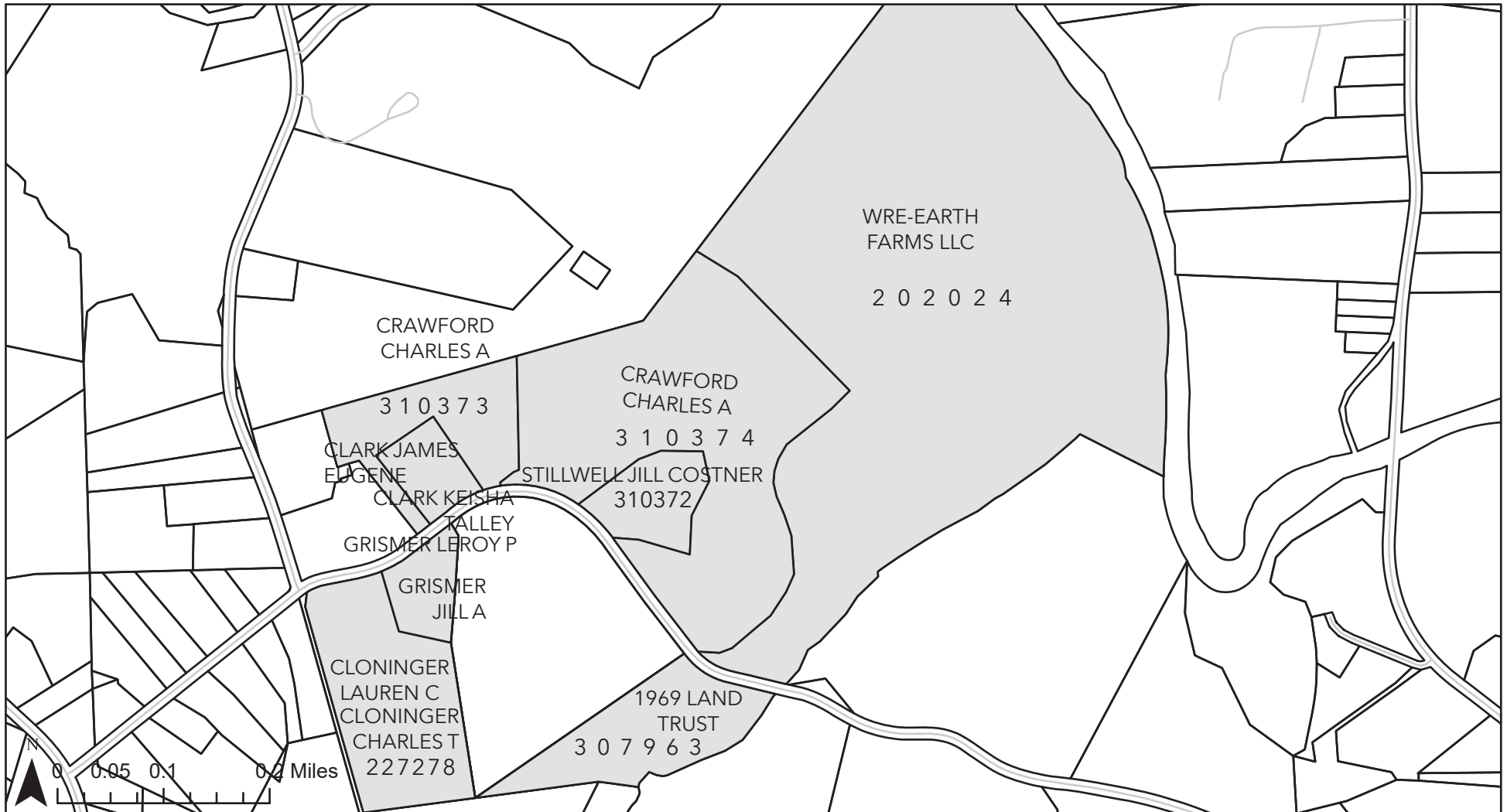

SUBJECT & ADJACENT PROPERTIES MAP | REZ-25-03-20-00221

Legend

- Subject Lot
- Adjacent Parcels

The information provided on this map is not intended to be considered as a legal document or description. The GIS data provided by Gaston County is made without warranty. Primary sources from which this data was compiled must be consulted for verification of the information contained within. This map may not be resold or otherwise used for trade or commercial purposes without the expressed written consent of Gaston County, in accordance with NCGS 132-10.