

GASTON COUNTY PUBLIC HEALTH - ENVIRONMENTAL HEALTH

SITE SKETCH

ate: 05/27/2025

PID: 145599

Permit Number: **339225**

REHS: M. Preston Long

Address: 4545 Crowders Crest Rd. Gastonia, NC 28052

Approved by Jamie Kanburoglu
for Presentation Only
09/29/2025 11:16:00 AM

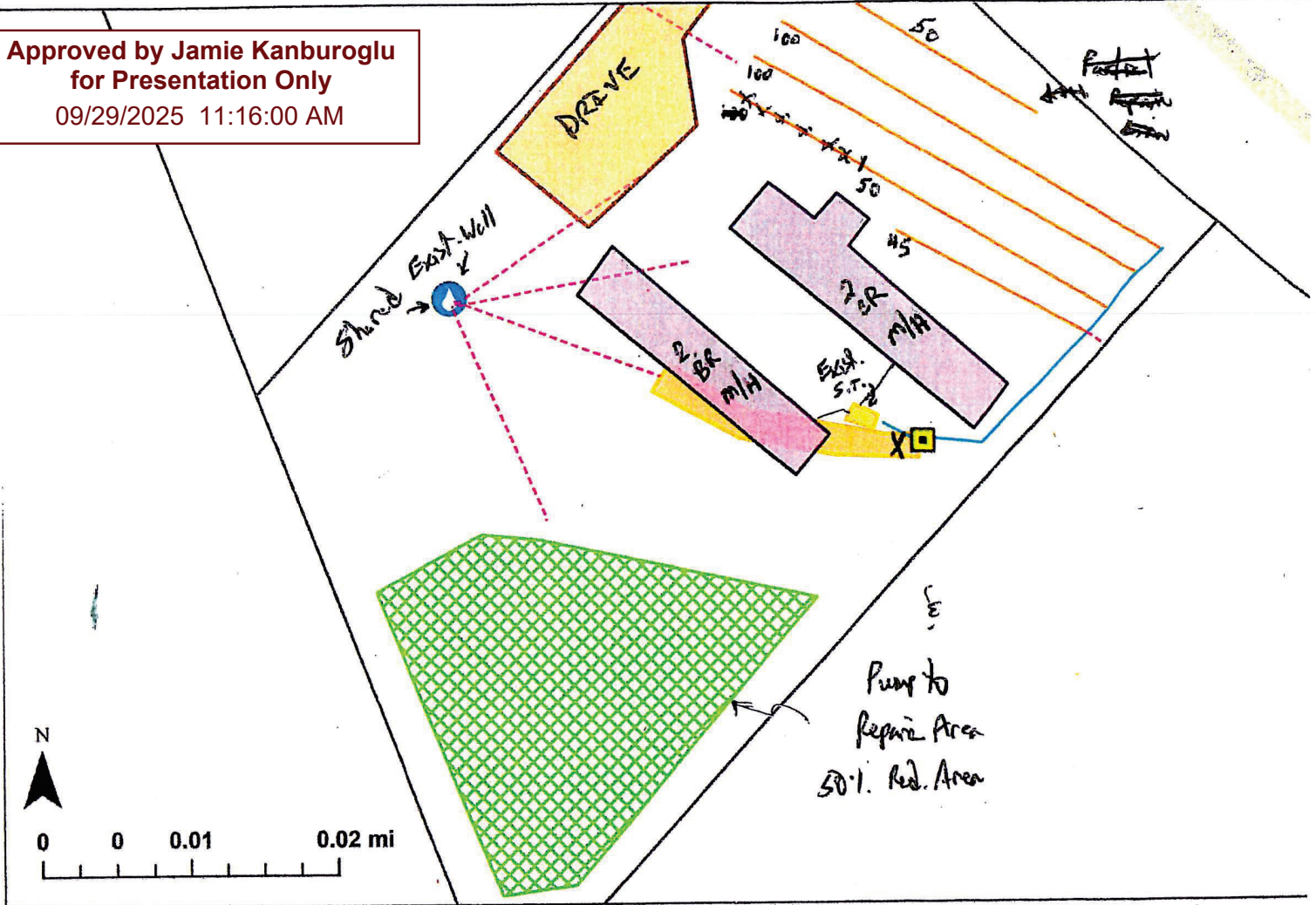

* Note: m/h #1 & m/h #2 should both be hooked to existing 1000 gal. S.T.

Setbacks:

All parts of septic system must be a min. of: 5' off foundations, 10' off prop lines, 50' off wells.

Specifications:

Keep all vehicular traffic off all parts septic system. Existing 1000 gal ST. Install 343 LF of 25% Red material. Serial feed.

Note: Must be 100' from existing well (on property) to septic system. "Shared Well"

Note: Ensure no effluent goes to existing bed, as it is under the rear m/h.