

**GASTON COUNTY**  
BUILDING AND DEVELOPMENT SERVICES

**VICINITY MAP**  
**REZ-24-06-05-00182**

**LEGEND**

- Roads
- Municipalities
- Subject Parcel(s)

The information provided on this map is not intended to be considered as a legal document or description. This map is believed to be accurate but Gaston County does not guarantee its accuracy. This map may not be resold or otherwise used for trade or commercial purposes without the expressed written consent of Gaston County, in accordance with NCGS 132-10.



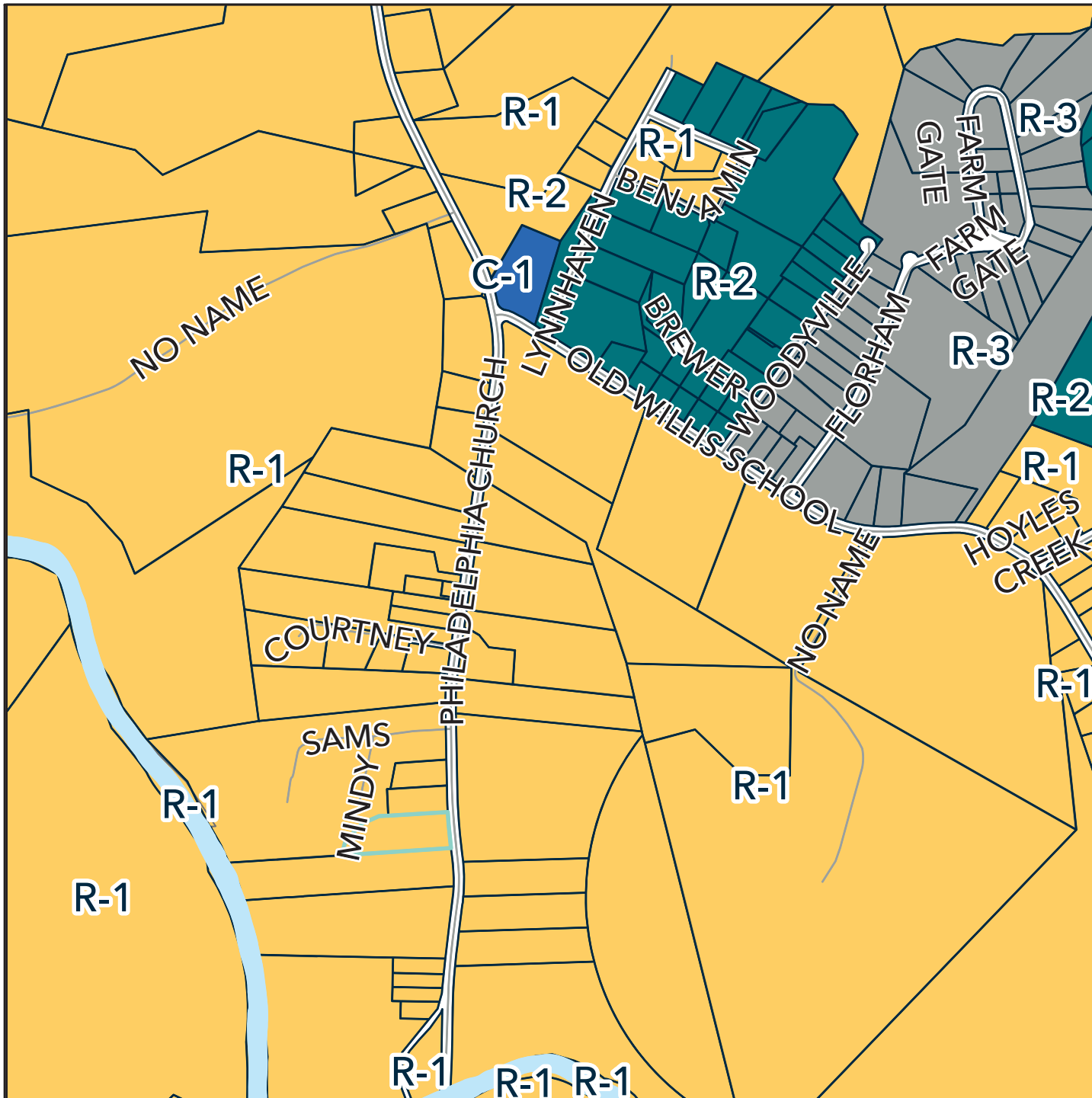

## ZONING MAP REZ-24-06-05-00182

### LEGEND

Subject Parcel

Roads

Parcels

#### ZONE TYPE

C-1

R-1

R-2

R-3

Rivers

The information provided on this map is not intended to be considered as a legal document or description. This map is believed to be accurate but Gaston County does not guarantee its accuracy. This map may not be resold or otherwise used for trade or commercial purposes without the expressed written consent of Gaston County, in accordance with NCGS 132-10.

0 0.05 0.1 0.2 Miles



N







**GASTON COUNTY**  
BUILDING AND DEVELOPMENT SERVICES  
**ORTHOPHOTO MAP**  
**REZ-24-06-05-00182**

**LEGEND**

-  Subject Parcel
-  Roads
-  Parcels
-  Rivers

The information provided on this map is not intended to be considered as a legal document or description. This map is believed to be accurate but Gaston County does not guarantee its accuracy. This map may not be resold or otherwise used for trade or commercial purposes without the expressed written consent of Gaston County, in accordance with NCGS 132-10.

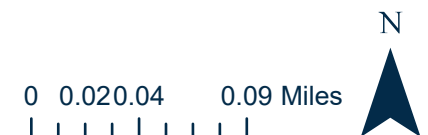



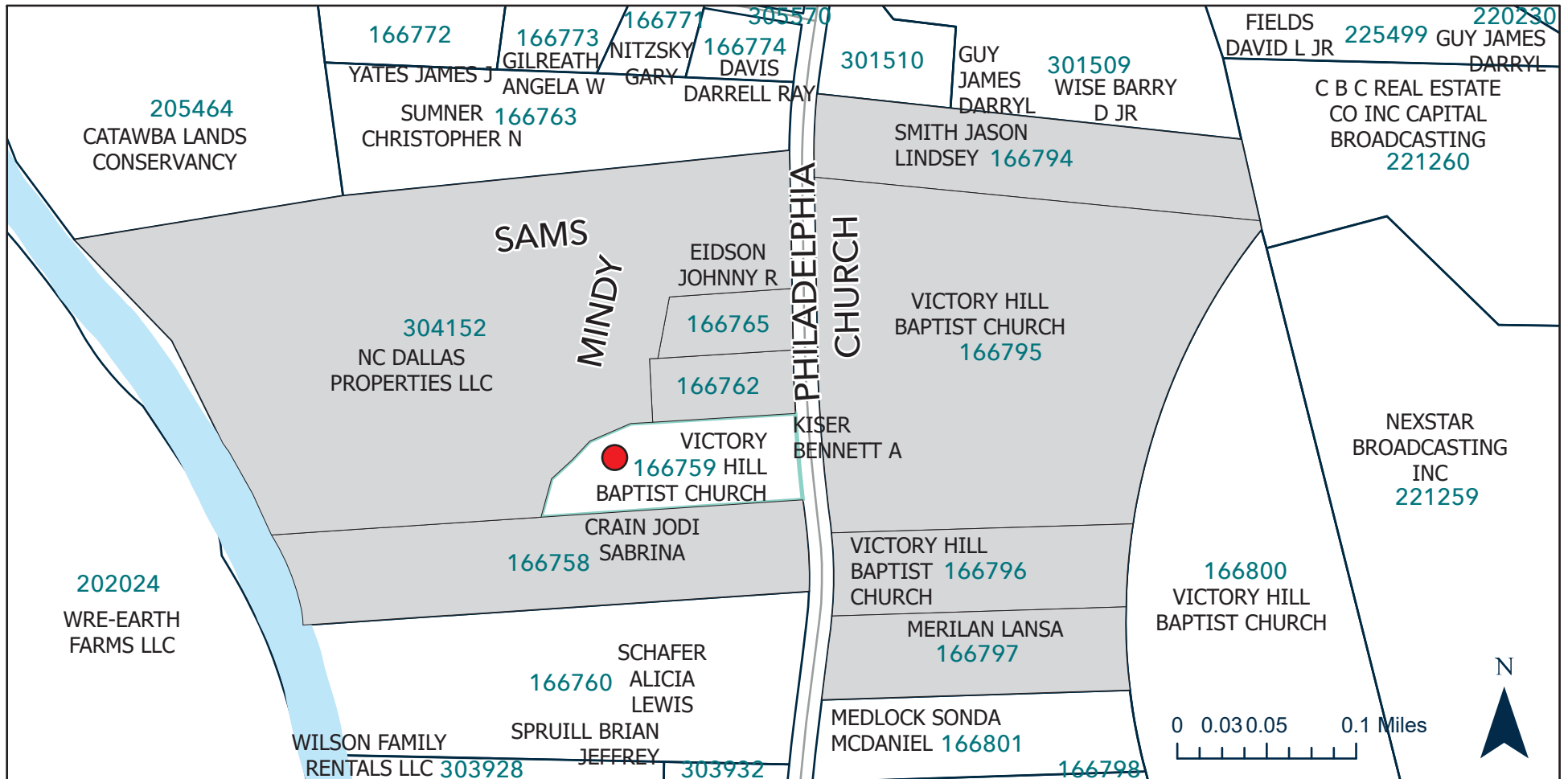

## SUBJECT & ADJACENT PROPERTIES MAP | REZ-24-06-05-00182

### LEGEND

 Subject Parcel(s)

The information provided on this map is not intended to be considered as a legal document or description. This map is believed to be accurate but Gaston County does not guarantee its accuracy. This map may not be resold or otherwise used for trade or commercial purposes without the expressed written consent of Gaston County, in accordance with NCGS 132-10.