

GASTON COUNTY
BUILDING AND DEVELOPMENT SERVICES

VICINITY MAP
REZ-23-07-21-00154

LEGEND

- Roads
- ▨ Municipalities
- Subject Parcel(s)

The information provided on this map is not intended to be considered as a legal document or description. This map is believed to be accurate but Gaston County does not guarantee its accuracy. This map may not be resold or otherwise used for trade or commercial purposes without the expressed written consent of Gaston County, in accordance with NCGS 132-10.

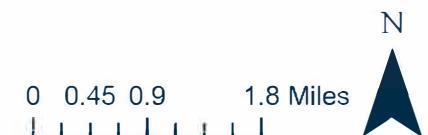

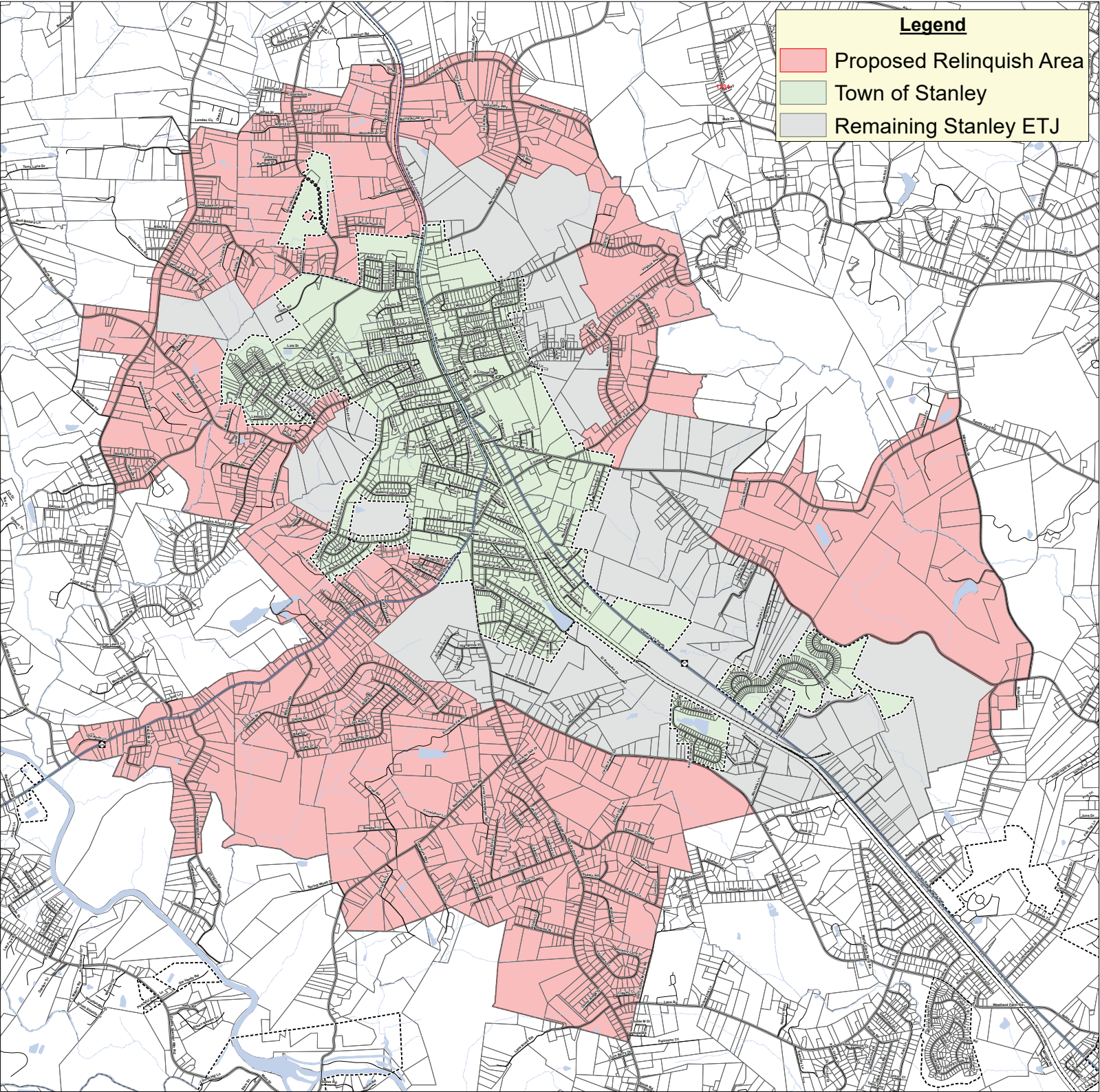

Legend

- Proposed Relinquish Area
- Town of Stanley
- Remaining Stanley ETJ



GASTON COUNTY
BUILDING AND DEVELOPMENT SERVICES

ORTHOPHOTO MAP
REZ-23-07-21-00154

LEGEND

- Roads
- Parcels
- Subject Parcel(s)

The information provided on this map is not intended to be considered as a legal document or description. This map is believed to be accurate but Gaston County does not guarantee its accuracy. This map may not be resold or otherwise used for trade or commercial purposes without the expressed written consent of Gaston County, in accordance with NCGS 132-10.

0 0.020.04 0.07 Miles



N



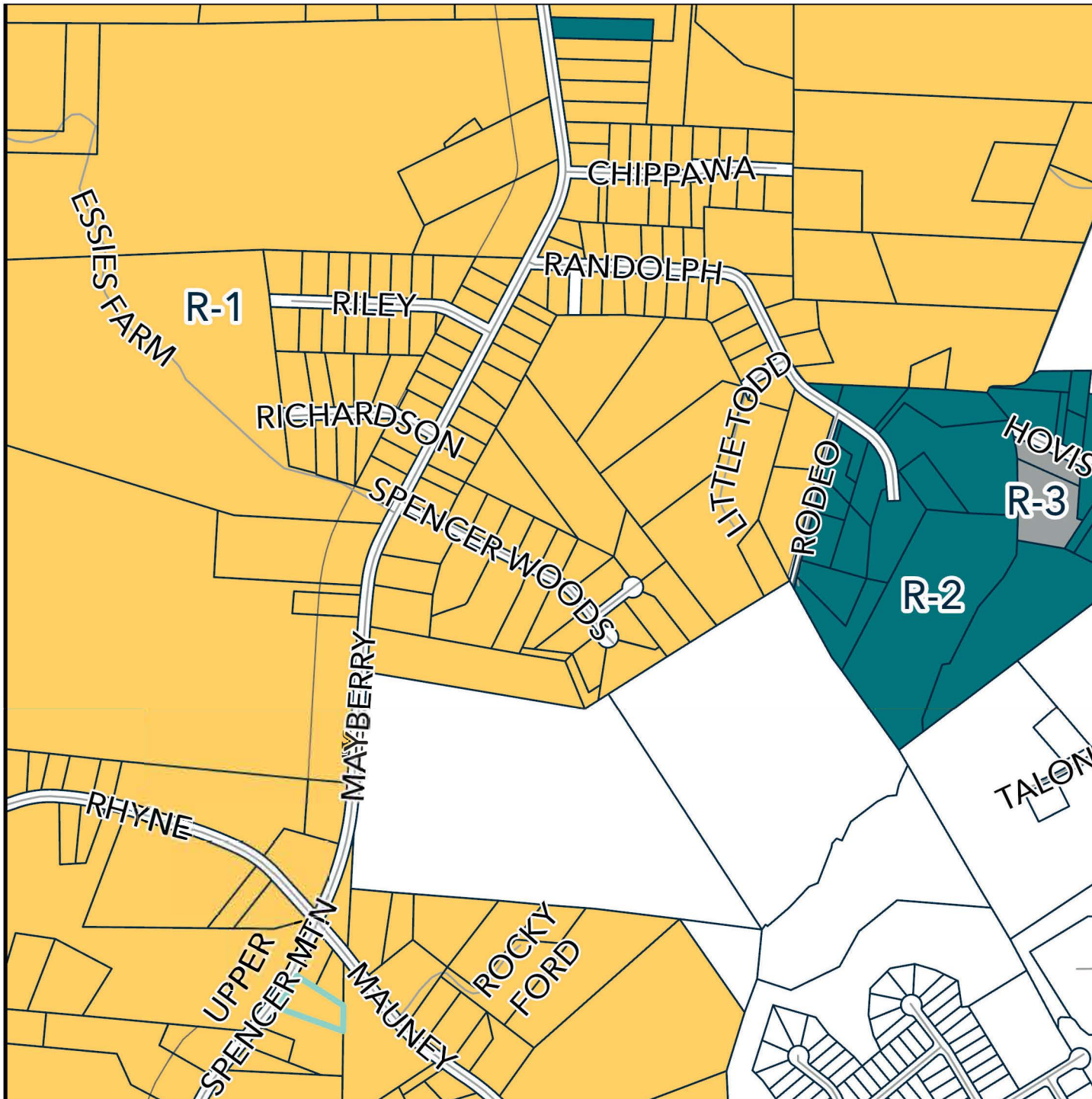

ZONING MAP REZ-23-07-21-00154

LEGEND

— Roads

□ Parcels

ZONE TYPE

■ R-1

■ R-2

■ R-3

□ Subject Parcel

The information provided on this map is not intended to be considered as a legal document or description. This map is believed to be accurate but Gaston County does not guarantee its accuracy. This map may not be resold or otherwise used for trade or commercial purposes without the expressed written consent of Gaston County, in accordance with NCGS 132-10.

0 0.05 0.1 0.19 Miles



N



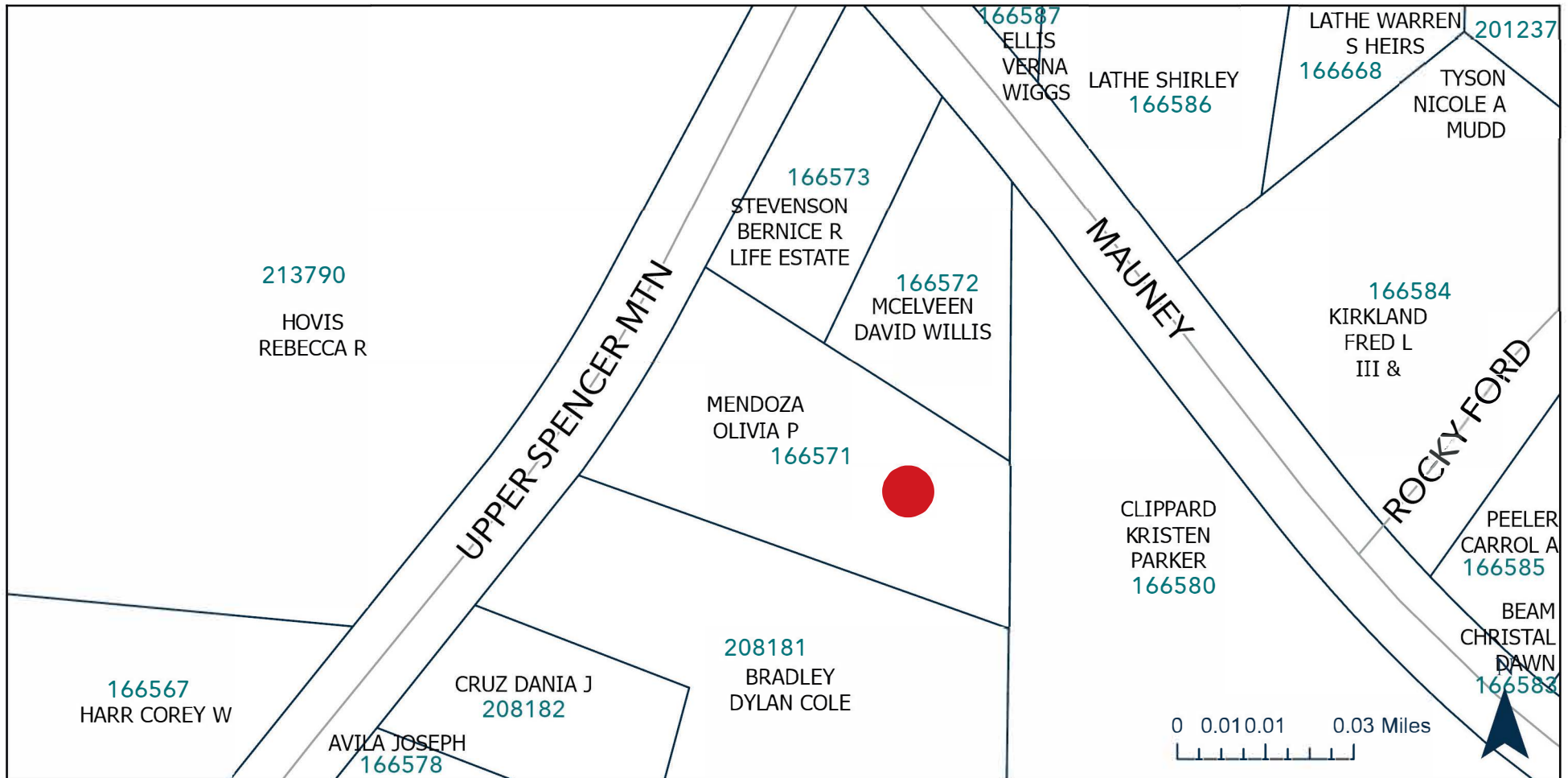

SUBJECT & ADJACENT PROPERTIES MAP | REZ-23-07-21-00154

LEGEND

 Subject Parcel(s)

The information provided on this map is not intended to be considered as a legal document or description. This map is believed to be accurate but Gaston County does not guarantee its accuracy. This map may not be resold or otherwise used for trade or commercial purposes without the expressed written consent of Gaston County, in accordance with NCGS 132-10.

Subject & Adjacent Parcel Owner's Information (REZ-00154)

PARCEL ID	NAME 1	NAME 2	ADDRESS	CITY	STATE	ZIP
166571	MENDOZA OLIVIA P	LARA JUAN PABLO JACOME	424 ANDREW CIRCLE LOT 26	GASTONIA	NC	28056
166572	MCELVEEN DAVID WILLIS	MCELVEEN MARITZA ESPERANZA	1125 MAUNEY ROAD	STANLEY	NC	28164
166573	STEVENSON BERNICE R LIFE ESTATE		1127 MAUNEY ROAD	STANLEY	NC	28164
166580	CLIPPARD DAVID ANTHONY	CLIPPARD KRISTEN PARKER	1121 MAUNEY RD	STANLEY	NC	28164
208181	BRADLEY DYLAN COLE		1040 UPPER SPENCER MOUNTAIN ROAD	STANLEY	NC	28164
213790	HOVIS RAY W	HOVIS REBECCA R	1043 UPPER SPENCER MTN RD	STANLEY	NC	28164