

Z22-12 GENERAL REZONING REQUEST

Applicant: Steven Davidson

Owner(s): Robert Bennett Jr.

Parcel: 175088

Location: 107 Henderson Street, Mount Holly

Request: Rezone from the (R-1) Single Family Limited Zoning District with (US) and (CH) Overlays to the (C-1) Light Commercial Zoning District with (US) and (CH) Overlays



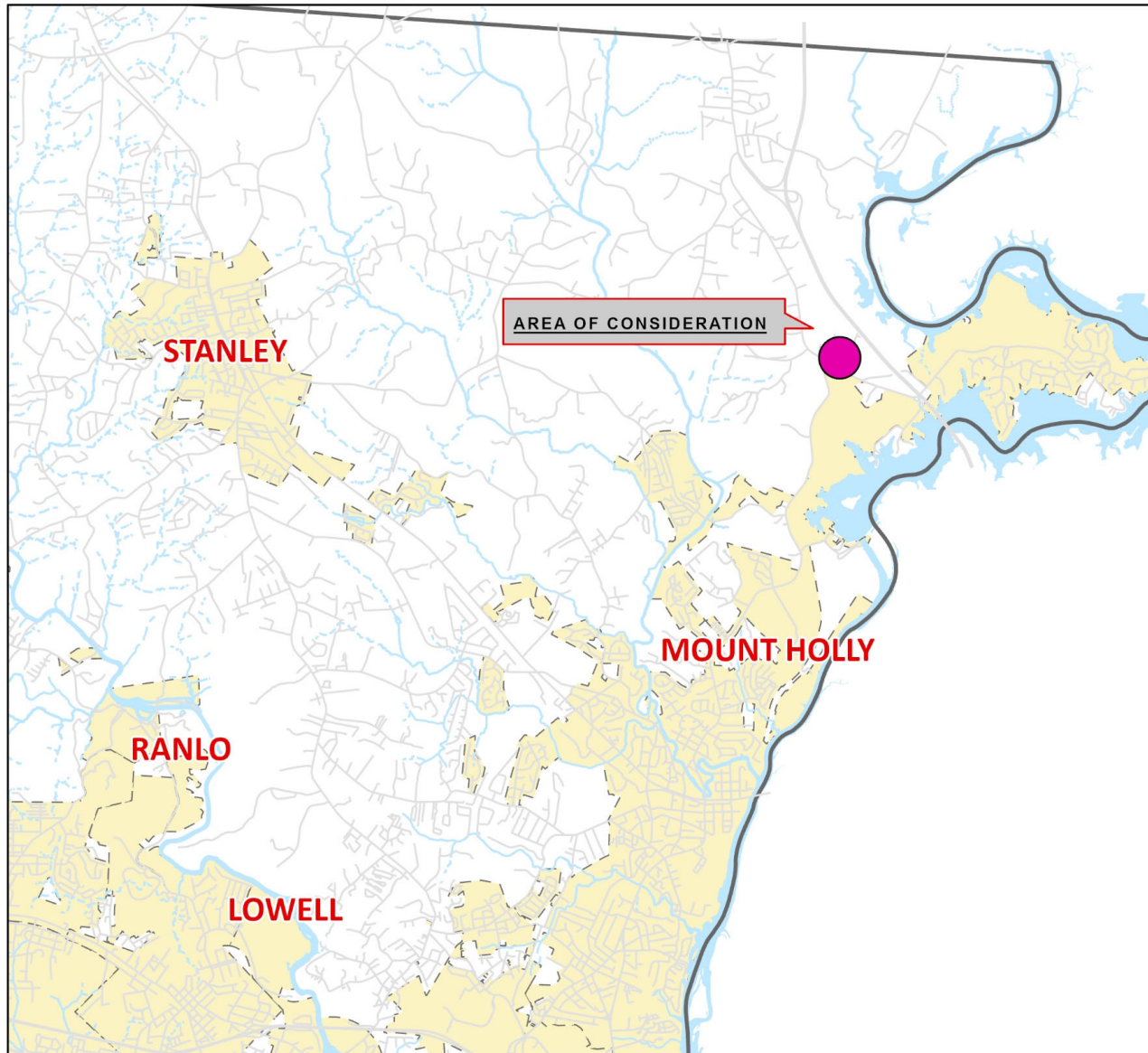

GASTON COUNTY
BUILDING AND DEVELOPMENT SERVICES

VICINITY MAP Z22-12

LEGEND

— Roads

■ Municipalities

● Area of Consideration

Although strict accuracy standards have been employed in the compilation of this map, Gaston County does not make or imply any warranties or assume any responsibility for the information presented on this map or its use.

This map may not be resold or otherwise used for trade or commercial purposes without the expressed written consent of Gaston County, in accordance with North Carolina General Statute 132-10.



0 0.5 1 Miles



ORTHOPHOTO MAP Z22-12

LEGEND

- Subject Area
- Property Parcels

This map is intended for use by the Gaston County Board of Commissioners, in the review of rezoning requests.

Property parcels, zoning, transportation, and other map information were compiled from one of more data layers. The data is periodically updated, however all data layers may not be displayed. Street names are subject to change.

Gaston County does not make or imply any warranties or assume any responsibility for the information presented on this map. This map was prepared by the Building and Development Services Department.

This map is for zoning purposes only - Not to be used for conveyance.

0 500 Feet

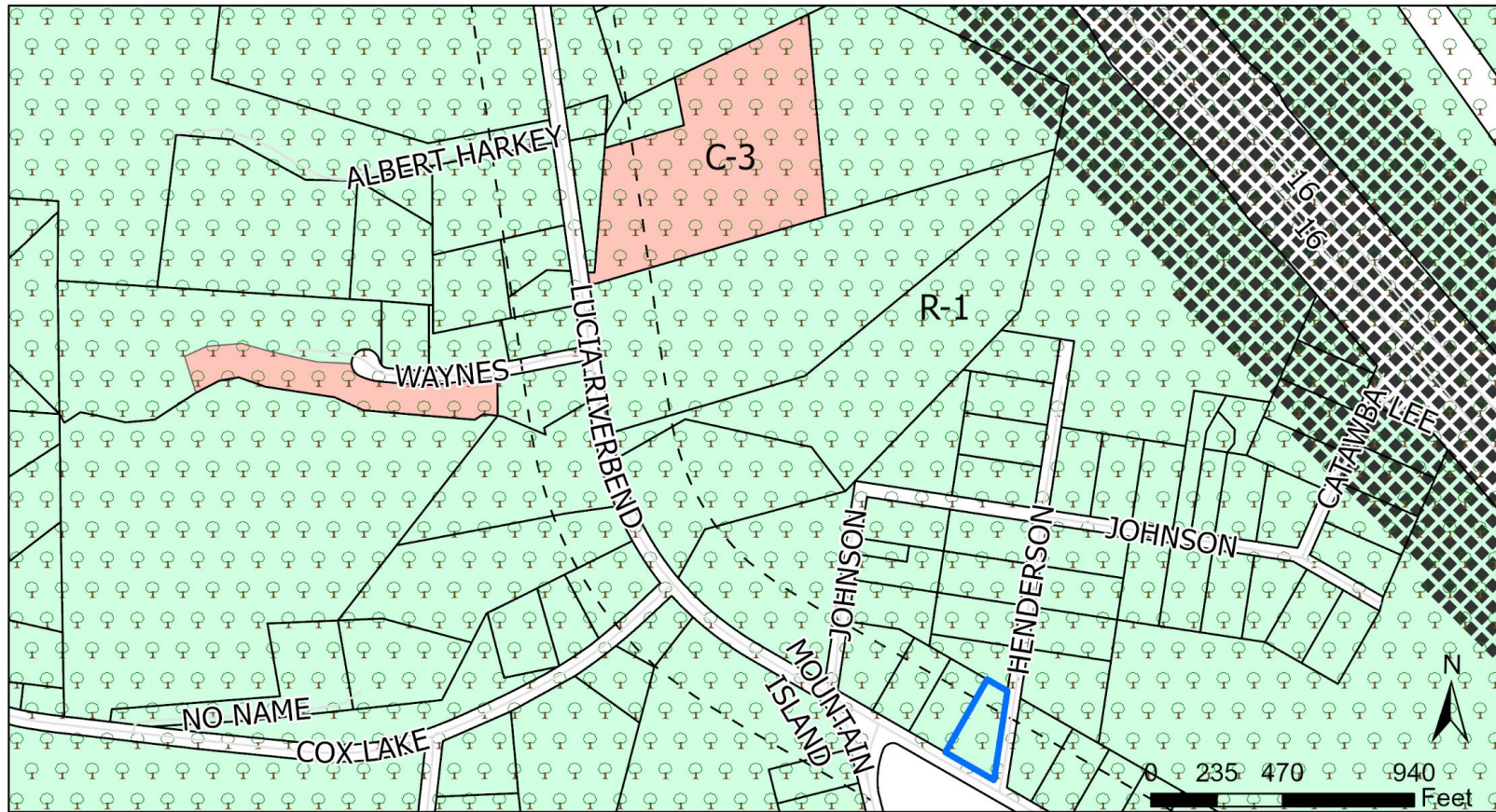

ZONING REVIEW MAP



Application Z22-12
Tax ID: 175088
Request: General Rezoning
From: (R-1) with (US) Overlay
To: (C-1) with (US) Overlay

Map Date: 03/29/2022

Gaston County Overlays

TYPE

- CH OVERLAY
- SH OVERLAY
- US OVERLAY

Gaston County UDO

ZONE TYPE

- C-3
- R-1
- Subject Property

This map is intended for use by the Gaston County Board of Commissioners, in the review of rezoning requests.

Property parcels, zoning, transportation, and other map information were compiled from one of more data layers. The data is periodically updated, however all data layers may not be displayed. Street names are subject to change.

Gaston County does not make or imply any warranties or assume any responsibility for the information presented on this map. This map was prepared by the Building and Development Services Department.

This map is for zoning purposes only - Not to be used for conveyance.

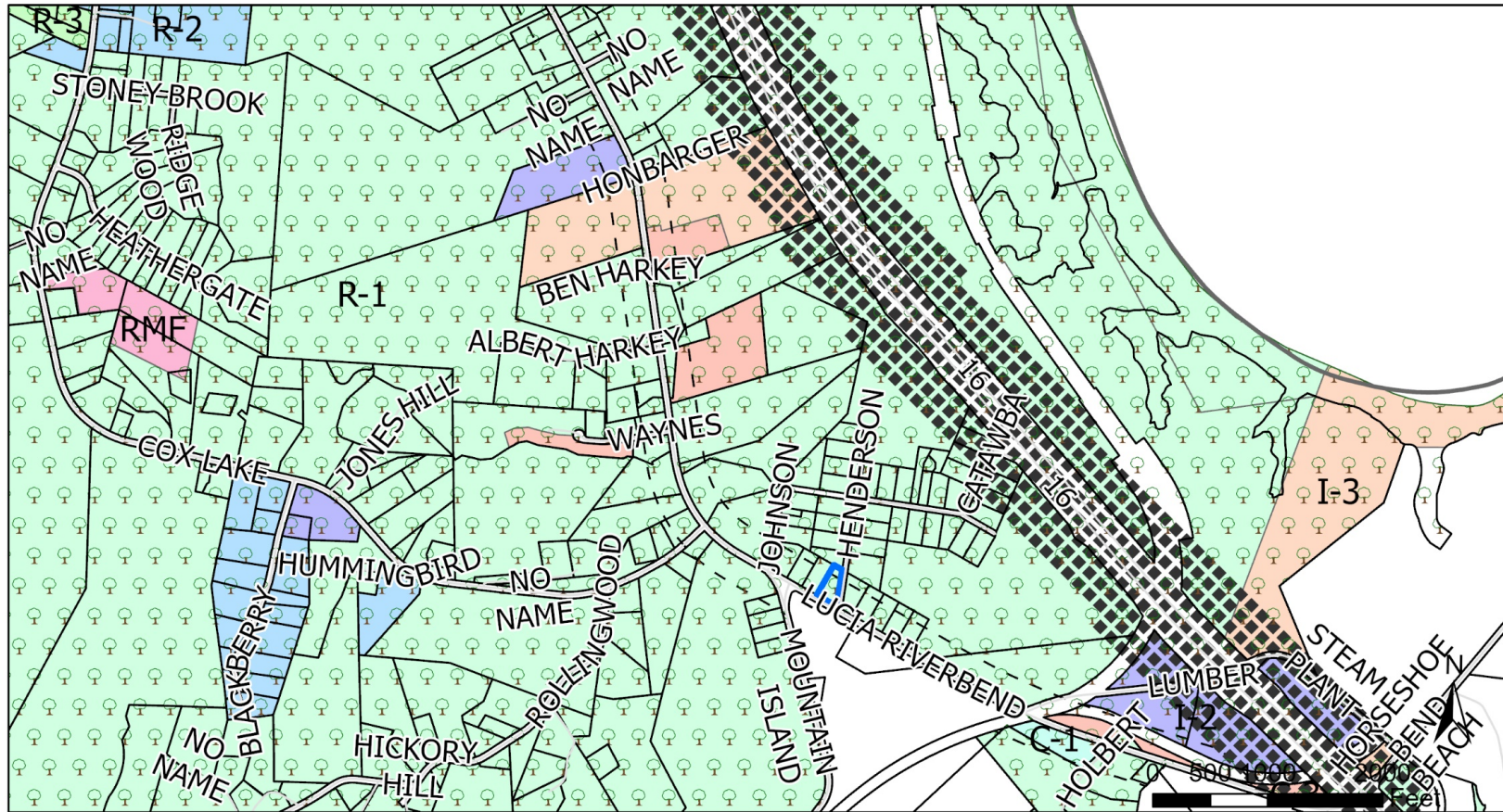

ZONING REVIEW MAP



Application Z22-12
Tax ID: 175088
Request: General Rezoning
From: (R-1) with (US) Overlay
To: (C-1) with (US) Overlay

Map Date: 03/29/2022

Gaston County Overlays	
CH OVERLAY	C-3
SH OVERLAY	I-2
US OVERLAY	I-3
Gaston County UDO	
ZONE TYPE	
C-1	R-1
	R-2
	R-3
	RMF
	Subject Property

This map is intended for use by the Gaston County Board of Commissioners, in the review of rezoning requests.

Property parcels, zoning, transportation, and other map information were compiled from one of more data layers. The data is periodically updated, however all data layers may not be displayed. Street names are subject to change.

Gaston County does not make or imply any warranties or assume any responsibility for the information presented on this map. This map was prepared by the Building and Development Services Department.

This map is for zoning purposes only - Not to be used for conveyance.



Adjacent Property Information

Z22-12 Subject and Adjacent Parcel Information

NO:	PARCEL	NAME 1	NAME 2	ADDRESS	CITY	STATE	ZIPCODE
*	175088	DOUGHERTY JOHN THOMAS		161 GRIFFIN RD	STANLEY	NC	28164
1	175094	COBB JOY ANNETTE P		116 HENDERSON ST	MT HOLLY	NC	28120
2	175089	LOFTIN CHRISTOPHER BRADLEY	LOFTIN PAMELA GRAVES	503 NIVENS COVE RD	MT HOLLY	NC	28120
3	222496	PROVIDENT DEV GROUP INC &	SAMUEL J STIGLER JR REV TRUST	6707 FARIVIEW RD SUITE B	CHARLOTTE	NC	28210
4	175087	DOUGHERTY JOHN THOMAS		161 GRIFFIN RD	STANLEY	NC	28164
5	175095	DOUGHERTY JOHN THOMAS		161 GRIFFIN RD	STANLEY	NC	28164

