

VICINITY MAP
REZ-23-03-15-00145

Legend

- Roads
- ▭ Municipalities
- Subject Property

Although strict standards have been employed in the compilation of this map, Gaston County does not make or imply any warranties or assume any responsibility for the information presented on this map or its use.



This map may not be resold or otherwise used for trade or commercial purposes without the expressed written consent of Gaston County, in accordance with North Carolina General Statute 132-10.



GASTON COUNTY
BUILDING AND DEVELOPMENT SERVICES

ORTHOPHOTO MAP REZ-23-03-15-00145

LEGEND

-  Subject Parcels
-  Property Parcels

This map is intended for use by the Gaston County Board of Commissioners, in the review of rezoning requests.

Property parcels, zoning, transportation, and other map information were compiled from one or more data layers. The data is periodically updated, however, all data layers may not be displayed. Street names are subject to change.

Gaston County does not make or imply any warranties or assume any responsibility for the information presented on this map. This map was prepared by the Building and Development Services Department.

This map is for zoning purposes only - Not to be used for conveyance.



Miles
0 0.01 0.01 0.03

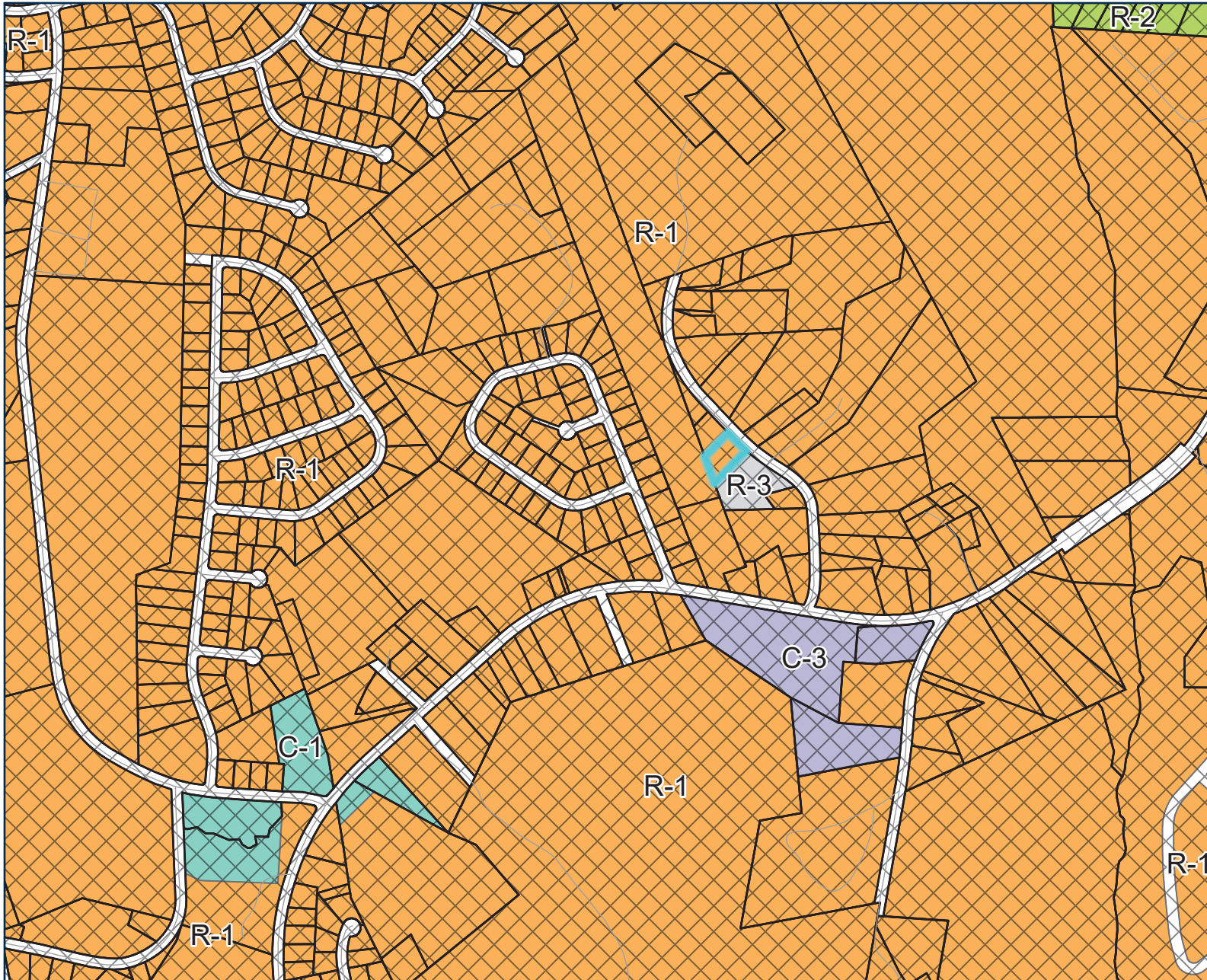

ZONING REVIEW MAP REZ-23-03-15-00145

Legend

- Property Parcels
- Roads

Gaston County Overlays

TYPE

- US OVERLAY

Gaston County UDO

ZONE TYPE

- C-1
- C-3
- R-1
- R-2
- R-3
- Parcels
- Gaston County Line
- 4545 Crowders Crest Drive



Miles

0 0.04 0.09 0.18

This map is intended for use by the Gaston County Board of Commissioners, in the review of rezoning requests.

Property parcels, zoning, transportation, and other map information were compiled from one or more data layers. The data is periodically updated, however, all data layers may not be displayed. Street names are subject to change.

Gaston County does not make or imply any warranties or assume any responsibility for the information presented on this map. This map was prepared by the Building and Development Services Department. This map is for zoning purposes only - Not to be used for conveyance.

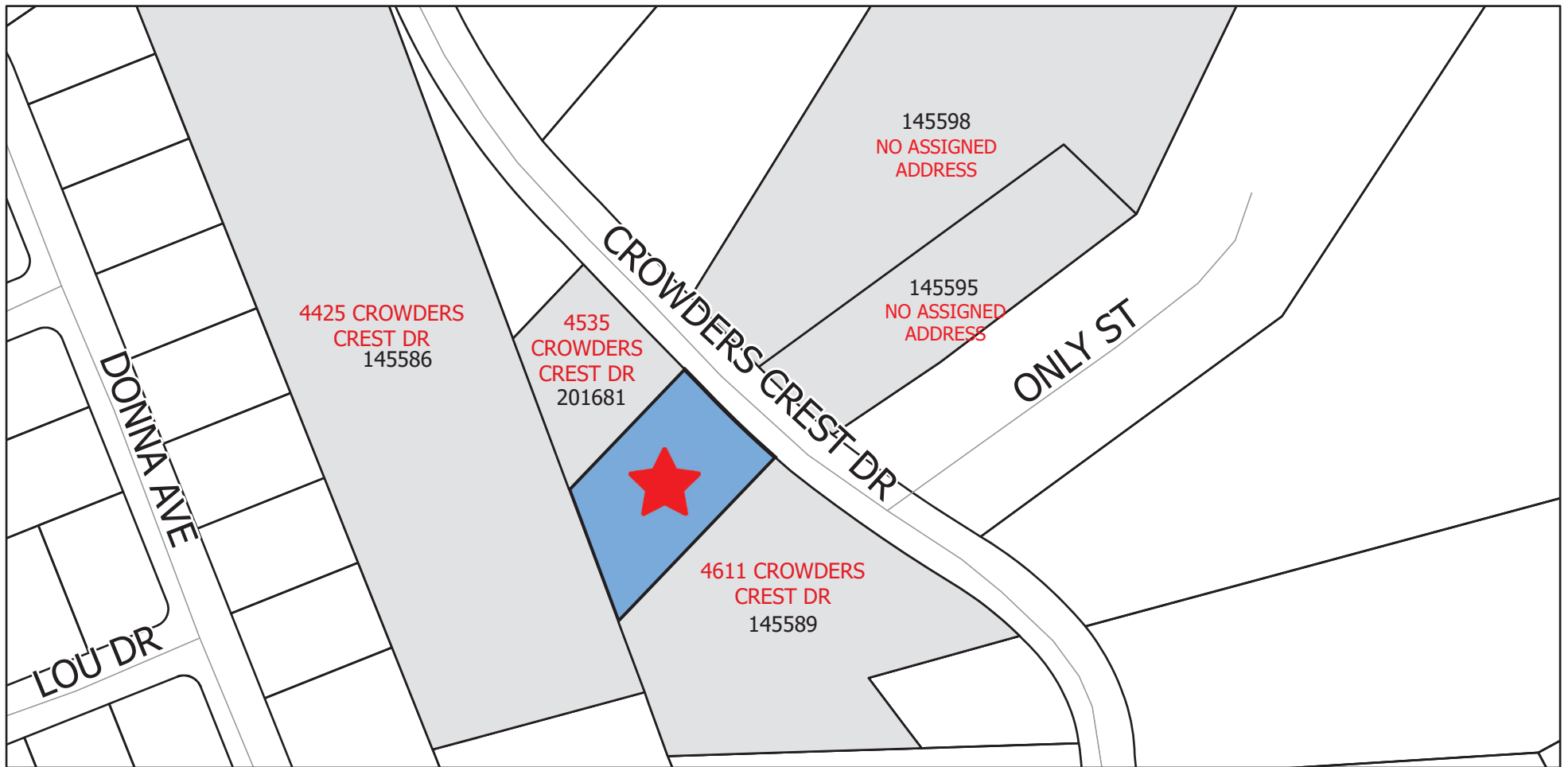

4545 Crowders Crest Drive Adjacent Parcels and Property Owners

NAME 1	NAME 2	ADDRESS	CITY	STATE	ZIPCODE
COURNEYA CAPPIE	JORDAN DEWAYNE L	213 BRENTWOOD CIRCLE	GASTONIA	NC	28052
WORLEY BILLY G	WORLEY TOKIE	3313 SHERWOOD CIR	GASTONIA	NC	28052
HANEY FAYE PRESSLEY HEIRS		4611 CROWDERS CREST DR	GASTONIA	NC	28052
HUGGINS F MICHAEL SR		4406 CROWDERS CREST ROAD	GASTONIA	NC	28052
MATTHEWS DEBRA DIANE	LUTZ KENNETH RAY JR	4535 CROWDERS CREST DR	GASTONIA	NC	28052
MATTHEWS JUDY BELL		4436 CROWDERS CREST DR	GASTONIA	NC	28052